

Map Lot U19-001

Account 1808

Location 822 BATH ROAD

Card 1 Of 1 10/05/2023

CEDERLUND, L.B. & H.A.
MAIN, JUDITH C.; TRUSTEE
WISCASSET ME 04578

B1651P294

Inspection Witnessed By:

X

Date

No./Date	Description	Date Insp.

Notes:

WISCASSET

Property Data

Neighborhood	200 U.S. RTE 1		
Tree Growth Year	0		
FARM LAND YEAR	0		
OPEN SPACE YEAR	0		
Zone/Land Use	21 RURAL		
Secondary Zone			
Topography	1 Level		
1.Level	4.Below St	7.Steep	
2.Rolling	5.Low	8.Rough	
3.Above St	6.Swampy	9.	
Utilities	2 Public Water	5 Dugwell/Lake	
1.Public	4.Dr Well	7.Cesspool	
2.Water	5.DUG/LAKE	8.	
3.Sewer	6.Septic	9.None	
Street	1 Paved		
1.Paved	4.Proposed	7.	
2.Semi Imp	5.Private	8.	
3.Gravel	6.Pub Eas	9.NoStreet	
TREE GROWTH PLAN	0		
CONSERV EASE	0		
Sale Data			
Sale Date			
Price			
Sale Type			
1.Land	4.Mobile	7.	
2.L & B	5.Other	8.	
3.Building	6.	9.	
Financing			
1.Convent	4.Seller	7.	
2.FHA/VA	5.Private	8.	
3.Assumed	6.Cash	9.Unknown	
Validity			
1.Valid	4.Split	7.Renovate	
2.Related	5.Partial	8.Other	
3.Distress	6.Exempt	9.Foreclose	
Verified			
1.Buyer	4.Agent	7.Family	
2.Seller	5.Pub Rec	8.Other	
3.Lender	6.MLS	9.	

Assessment Record

Year	Land	Buildings	Exempt	Total
2010	91,500	100,300	16,000	175,800
2011	91,500	100,300	16,000	175,800
2012	91,500	100,300	16,000	175,800
2013	91,500	100,300	16,000	175,800
2014	91,500	100,300	16,000	175,800
2015	91,500	100,300	16,000	175,800
2016	91,500	100,300	21,000	170,800
2017	91,500	100,300	26,000	165,800
2018	91,500	100,300	26,000	165,800
2019	91,500	100,300	26,000	165,800
2020	91,500	100,300	31,000	160,800
2021	91,500	100,300	31,000	160,800
2022	91,500	100,300	29,760	162,040
2023	114,400	125,400	31,000	208,800

Land Data

Front Foot	Type	Effective		Influence		Influence Codes
		Frontage	Depth	Factor	Code	
11.Regular Lot				%		1.Open Space
12.Delta Triangle				%		2.Neighborhood A
13.Nabla Triangle				%		3.Topography
14.Rear Land				%		4.Size/Shape
15.Front Foot				%		5.Access
				%		6.Restriction
				%		7.Corner/Locatio
				%		8.View/Environ
				%		9.Fract Share
				%		Acres
				%		30.Rear 20+
				%		31.Waterfront Rea
				%		32.Open Space
				%		33.RestrictEsm
				%		34.PASTURE 1
				%		35.HORTICULTURAL-
				%		36.Pasture 3
				%		37.Softwood
				%		38.Mixed Wood
				%		39.Hardwood
				%		40.Wasteland
				%		41.CAMP SITE
				%		42.Mobile Home Si
				%		43.Condo Site
				%		44.Site Improve
				%		45.CAMP SITE
				%		46.PAVING/00
Total Acreage		0.76				

WISCASSET

Map Lot U19-001

Account 1808

Location 822 BATH ROAD

Card 1

Of 1

10/05/2023

Building Style 2 Ranch	SF Bsmt Living 0	Layout 1 Typical
1.Conv. 5.Colonial 9.Other	Fin Bsmt Grade 0 0	1.Typical 4. 7.
2.Ranch 6.Split 10.Double	HEARTH 1	2.Inadeq 5. 8.
3.R Ranch 7.Mod/Cont 11.Multi	Heat Type 100% 1 Hot Water BB	3. 6. 9.
4.Cape 8.Log 12.Cot.	1.HWBB 5.FWA 9.No Heat	Attic 5 Floor & Stairs
Dwelling Units 1	2.HWCI 6.GravWA 10.	1.1/4 Fin 4.Full Fin 7.
Other Units 1	3.H Pump 7.Electric 11.	2.1/2 Fin 5.F/Stair 8.
Stories 1 One Story	4.Steam 8.F/Wall 12.	3.3/4 Fin 6. 9.None
1.1 4.1.5 7.	Cool Type 0% 9 None	Insulation 1 Full
2.2 5.1.75 8.	1.Refrig 4.W&C Air 7.	1.Full 4.Minimal 7.
3.3 6.2.5 9.	2.Evapor 5. 8.	2.Heavy 5.Unknown 8.
Exterior Walls 8 ALUM/VINYL	3.H Pump 6. 9.None	3.Capped 6. 9.None
1.CLAP 5.T-111 9.OTHER	Kitchen Style 2 TYPICAL	Unfinished % 0%
2.WD SH 6.BR/STONE 10.	1.GOOD 4.Obsolete 7.	Grade & Factor 3 Average 105%
3.COMP 7.NOV 11.	2.TYPICAL 5. 8.	1.E Grade 4.B Grade 7.AA+ Grad
4.ASB/ASP 8.AL/VIN 12.	3.OLD TYPE 6. 9.None	2.D Grade 5.A Grade 8.AA++Grad
Roof Surface 1 Asphalt Shingles	Bath(s) Style 2 TYPICAL	3.C Grade 6.AA Grade 9.Same
1.Asphalt 4.Composit 7.	1.GOOD 4.Obsolete 7.	SQFT (Footprint) 1140
2.Slate 5.Wood 8.	2.TYPICAL 5. 8.	Condition 3 Below Average
3.Metal 6.Other 9.	3.Old Type 6. 9.None	1.Poor 4.Avg 7.V G
SF Masonry Trim 0	# Rooms 5	2.Fair 5.Avg+ 8.Exc
OPEN-3-CUSTOM 0	# Bedrooms 3	3.Avg- 6.Good 9.Same
OPEN-4-CUSTOM 0	# Full Baths 1	Phys. % Good 0%
Year Built 1956	# Half Baths 0	Funct. % Good 100%
Year Remodeled 0	# Addn Fixtures 0	Functional Code 9 None
Foundation 2 Concrete Block	# Fireplaces 1	1.Incomp 4.SMALL 7.LAYOUT
1.Concrete 4.Wood 7.		2.O-Built 5.CDU 8.OTHER
2.C Block 5.Slab 8.		3.Defmaint 6.STYLE 9.None
3.Br/Stone 6.Piers 9.		Econ. % Good 100%
Basement 4 Full Basement		Economic Code None
1.1/4 Bmt 4.Full Bmt 7.		0.None 3.Services 9.None
2.1/2 Bmt 5.None 8.		1.Location 4.Traffic 8.
3.3/4 Bmt 6. 9.None		2.Encroach 8.Other 9.
Bsmt Gar # Cars 0		Entrance Code 1 Interior Inspect
Wet Basement 3 Wet Basement		1.Interior 4.Vacant 7.
1.Dry 4. 7.		2.Refusal 5.Estimate 8.
2.Damp 5. 8.		3.Informed 6. 9.
3.Wet 6. 9.		Information Code 1 Owner
		1.Owner 4.Agent 7.
		2.Relative 5.Estimate 8.
		3.Tenant 6.Other 9.

Date Inspected 3/28/2007

Additions, Outbuildings & Improvements

Type	Year	Units	Grade	Cond	Phys.	Funct.	Sound Value	
22 Encl Frame Porch	0	60	0 0	0	0 %	0 %		1.ONE STORY FRAM
22 Encl Frame Porch	0	121	0 0	0	0 %	0 %		2.TWO STORY FRAM
23 Frame Garage	0	440	0 0	0	0 %	100 %		3.THREE STORY FR
23 Frame Garage	1960	592	4 100	3	0 %	100 %		4.1 & 1/2 STORY
					%	%		5.1 & 3/4 STORY
					%	%		6.2 & 1/2 STORY
					%	%		21.Open Frame Por
					%	%		22.Encl Frame Por
					%	%		23.Frame Garage
					%	%		24.Frame Shed
					%	%		25.Frame Bay Wind
					%	%		26.1SFr Overhang
					%	%		27.Unfin Basement
					%	%		28.Unfinished Att
					%	%		29.Finished Attic

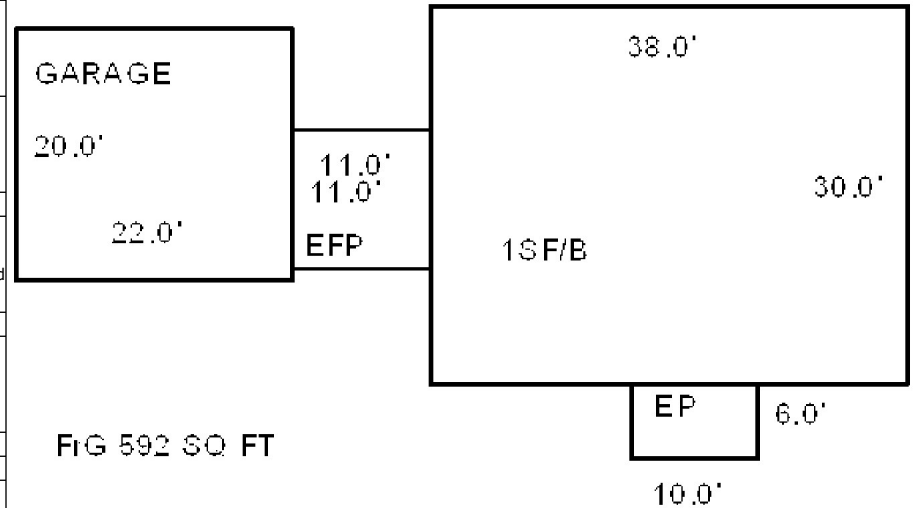

Map Lot U19-002

Account 1809

Location 830 BATH ROAD

Card 1 Of 1 10/05/2023

HARRISON, RONALD L HARRISON, DEBRA A 830 BATH ROAD WISCASSET ME 04578 B855P178 B5265P120			Property Data			Assessment Record					
			Neighborhood 200 U.S. RTE 1			Year	Land	Buildings	Exempt	Total	
			Tree Growth Year 0			2010	112,100	92,400	16,000	188,500	
			FARM LAND YEAR 0			2011	112,100	92,400	16,000	188,500	
			OPEN SPACE YEAR 0			2012	112,100	92,400	16,000	188,500	
			Zone/Land Use 21 RURAL			2013	112,100	92,400	16,000	188,500	
			Secondary Zone 14 S-R			2014	112,100	92,400	16,000	188,500	
						2015	112,100	92,400	16,000	188,500	
			Topography 1 Level			2016	112,100	92,400	21,000	183,500	
						2017	112,100	92,400	26,000	178,500	
			1.Level 4.Below St 7.Steep 2.Rolling 5.Low 8.Rough 3.Above St 6.Swampy 9.			2018	112,100	92,400	26,000	178,500	
			Utilities 4 Drilled Well 6 Septic System			2019	112,100	104,200	20,000	196,300	
			1.Public 4.Dr Well 7.Cesspool 2.Water 5.DUG/LAKE 8. 3.Sewer 6.Septic 9.None			2020	112,100	104,200	25,000	191,300	
						2021	112,100	104,200	25,000	191,300	
						2022	112,100	104,200	24,000	192,300	
			Street 1 Paved			2023	140,100	130,200	25,000	245,300	
			1.Paved 4.Proposed 7. 2.Semi Imp 5.Private 8. 3.Gravel 6.Pub Eas 9.NoStreet								
			TREE GROWTH PLAN 0								
			CONSERV EASE 0								
Inspection Witnessed By:			Sale Data								
			Sale Date 6/06/2018								
			Price 135,000								
			Sale Type 2 Land & Buildings								
			1.Land 4.Mobile 7. 2.L & B 5.Other 8. 3.Building 6. 9.								
X			Financing 9 Unknown								
			1.Convent 4.Seller 7. 2.FHA/VA 5.Private 8. 3.Assumed 6.Cash 9.Unknown								
			Validity 8 Other Non Valid								
			1.Valid 4.Split 7.Renovate 2.Related 5.Partial 8.Other 3.Distress 6.Exempt 9.Foreclose								
Notes:			Verified 5 Public Record								
			1.Buyer 4.Agent 7.Family 2.Seller 5.Pub Rec 8.Other 3.Lender 6.MLS 9.								
WISCASSET											

WISCASSET

WISCASSET

Map Lot U19-002

Account 1809

Location 830 BATH ROAD

Card 1

Of 1

10/05/2023

Building Style 4 Cape Cod	SF Bsmt Living 0	Layout 1 Typical
1.Conv. 5.Colonial 9.Other	Fin Bsmt Grade 0 0	1.Typical 4. 7.
2.Ranch 6.Split 10.Double	HEARTH 0	2.Inadeq 5. 8.
3.R Ranch 7.Mod/Cont 11.Multi	Heat Type 100% 2 Hot Water C Iron	3. 6. 9.
4.Cape 8.Log 12.Cot.	1.HWBB 5.FWA 9.No Heat	Attic 4 Full Finished
Dwelling Units 1	2.HWCI 6.GravWA 10.	1.1/4 Fin 4.Full Fin 7.
Other Units 0	3.H Pump 7.Electric 11.	2.1/2 Fin 5.F/Stair 8.
Stories 1 One Story	4.Steam 8.F/Wall 12.	3.3/4 Fin 6. 9.None
1.1 4.1.5 7.	Cool Type 0% 9 None	Insulation 1 Full
2.2 5.1.75 8.	1.Refrig 4.W&C Air 7.	1.Full 4.Minimal 7.
3.3 6.2.5 9.	2.Evapor 5. 8.	2.Heavy 5.Unknown 8.
Exterior Walls 8 ALUM/VINYL	3.H Pump 6. 9.None	3.Capped 6. 9.None
1.CLAP 5.T-111 9.OTHER	Kitchen Style 2 TYPICAL	Unfinished % 0%
2.WD SH 6.BR/STONE 10.	1.GOOD 4.Obsolete 7.	Grade & Factor 3 Average 105%
3.COMP 7.NOV 11.	2.TYPICAL 5. 8.	1.E Grade 4.B Grade 7.AA+ Grad
4.ASB/ASP 8.AL/VIN 12.	3.OLD TYPE 6. 9.None	2.D Grade 5.A Grade 8.AA++Grad
Roof Surface 1 Asphalt Shingles	Bath(s) Style 2 TYPICAL	3.C Grade 6.AA Grade 9.Same
1.Asphalt 4.Composit 7.	1.GOOD 4.Obsolete 7.	SQFT (Footprint) 1140
2.Slate 5.Wood 8.	2.TYPICAL 5. 8.	Condition 4 Average
3.Metal 6.Other 9.	3.Old Type 6. 9.None	1.Poor 4.Avg 7.V G
SF Masonry Trim 0	# Rooms 5	2.Fair 5.Avg+ 8.Exc
OPEN-3-CUSTOM 0	# Bedrooms 3	3.Avg- 6.Good 9.Same
OPEN-4-CUSTOM 0	# Full Baths 1	Phys. % Good 0%
Year Built 1955	# Half Baths 0	Funct. % Good 100%
Year Remodeled 0	# Addn Fixtures 0	Functional Code 9 None
Foundation 2 Concrete Block	# Fireplaces 1	1.Incomp 4.SMALL 7.LAYOUT
1.Concrete 4.Wood 7.		2.O-Built 5.CDU 8.OTHER
2.C Block 5.Slab 8.		3.Defmaint 6.STYLE 9.None
3.Br/Stone 6.Piers 9.		Econ. % Good 100%
Basement 4 Full Basement		Economic Code None
1.1/4 Bmt 4.Full Bmt 7.		0.None 3.Services 9.None
2.1/2 Bmt 5.None 8.		1.Location 4.Traffic 8.
3.3/4 Bmt 6. 9.None		2.Encroach 8.Other 9.
Bsmt Gar # Cars 0		Entrance Code 5 Estimated
Wet Basement 1 Dry Basement		1.Interior 4.Vacant 7.
1.Dry 4. 7.		2.Refusal 5.Estimate 8.
2.Damp 5. 8.		3.Informed 6. 9.
3.Wet 6. 9.		Information Code 5 Estimate
		1.Owner 4.Agent 7.
		2.Relative 5.Estimate 8.
		3.Tenant 6.Other 9.

Date Inspected 12/08/2006

Additions, Outbuildings & Improvements

Type	Year	Units	Grade	Cond	Phys.	Funct.	Sound Value	
22 Encl Frame Porch	0	96	0 0	0	0 %	0 %		1.ONE STORY FRAM
23 Frame Garage	0	420	0 0	0	0 %	0 %		2.TWO STORY FRAM
24 Frame Shed	0	168	0 0	0	0 %	0 %		3.THREE STORY FR
22 Encl Frame Porch	0	60	0 0	0	0 %	0 %		4.1 & 1/2 STORY
					%	%		5.1 & 3/4 STORY
					%	%		6.2 & 1/2 STORY
					%	%		21.Open Frame Por
					%	%		22.Encl Frame Por
					%	%		23.Frame Garage
					%	%		24.Frame Shed
					%	%		25.Frame Bay Wind
					%	%		26.1SFr Overhang
					%	%		27.Unfin Basement
					%	%		28.Unfinished Att
					%	%		29.Finished Attic

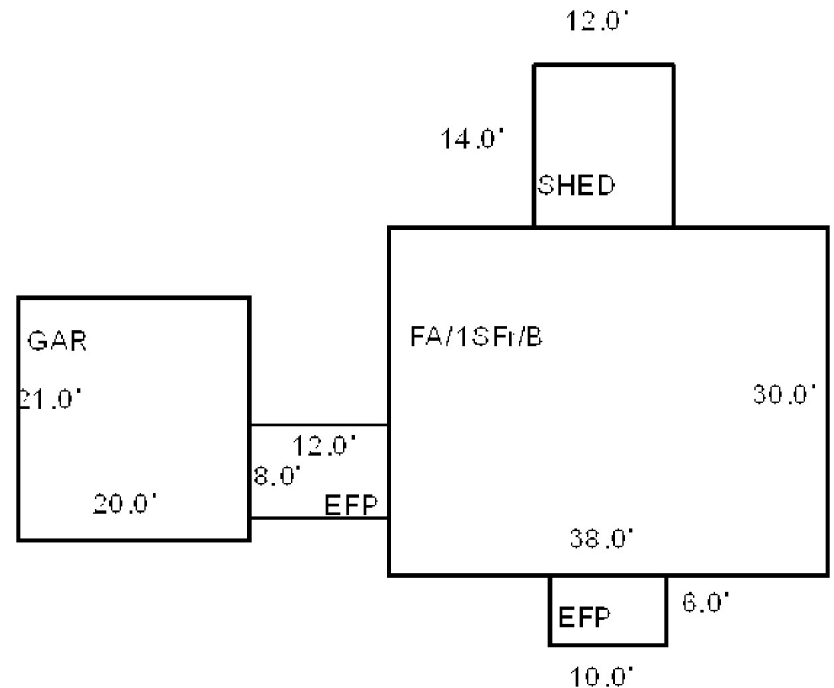

Map Lot U19-003

Account 1810

Location BATH ROAD

Card 1 Of 1 10/05/2023

SEWALL, NICHOLAS S
BATH ME 04530

B4063P198 B4234P33 B4234P37

Previous Owner
SEWALL, NICHOLAS S. & ANN C. SLOCUM
TRUSTEES OF THE SEWALL FAMILY TRUST
C/O NICHOLAS SEWALL
BATH ME 04530
Sale Date: 12/18/2009

Previous Owner
SEWALL, NICHOLAS S.
SLOCUM, ANN C.
C/O NICHOLAS SEWALL
BATH ME 04530
Sale Date: 10/22/2008

Previous Owner
SEWALL, HELEN
C/O NICHOLAS SEWALL
42 FRONT STREET
BATH ME 04530

Inspection Witnessed By:

X	Date	
No./Date	Description	Date Insp.

Notes:

2009-Deed of Distribution putting into Revocable Trust and then deed putting into Sewall Family Trust as Trustees, previous BK3254 PG52.

2010-Confirmatory deed of distribution recorded 12/18/09 BK4234 PG33 and Deed of sale by Trustees recorded 12/18/09 BK4234 PG37 into Nicholas S. Sewall name only.

WISCASSET

Property Data			Assessment Record				
Neighborhood 200 U.S. RTE 1 Tree Growth Year 0 FARM LAND YEAR 0 OPEN SPACE YEAR 0 Zone/Land Use 21 RURAL Secondary Zone 14 S-R Topography 1 Level 1.Level 4.Below St 7.Steep 2.Rolling 5.Low 8.Rough 3.Above St 6.Swampy 9. Utilities 1 All Public 1.Public 4.Dr Well 7.Cesspool 2.Water 5.DUG/LAKE 8. 3.Sewer 6.Septic 9.None Street 1 Paved 1.Paved 4.Proposed 7. 2.Semi Imp 5.Private 8. 3.Gravel 6.Pub Eas 9.NoStreet TREE GROWTH PLAN 0 CONSERV EASE 0 Sale Data Sale Date 12/18/2009 Price Sale Type 1 Land Only 1.Land 4.Mobile 7. 2.L & B 5.Other 8. 3.Building 6. 9. Financing 9 Unknown 1.Convent 4.Seller 7. 2.FHA/VA 5.Private 8. 3.Assumed 6.Cash 9.Unknown Validity 2 Related Parties 1.Valid 4.Split 7.Renovate 2.Related 5.Partial 8.Other 3.Distress 6.Exempt 9.Foreclose Verified 5 Public Record 1.Buyer 4.Agent 7.Family 2.Seller 5.Pub Rec 8.Other 3.Lender 6.MLS 9.			Year	Land	Buildings	Exempt	Total
			2010	53,200	0	0	53,200
			2011	53,200	0	0	53,200
			2012	53,200	0	0	53,200
2013	53,200	0	0	53,200			
2014	53,200	0	0	53,200			
2015	53,200	0	0	53,200			
2016	53,200	0	0	53,200			
2017	53,200	0	0	53,200			
2018	53,200	0	0	53,200			
2019	53,200	0	0	53,200			
2020	53,200	0	0	53,200			
2021	53,200	0	0	53,200			
2022	53,200	0	0	53,200			
2023	66,600	0	0	66,600			
Land Data							
Front Foot 11.Regular Lot 12.Delta Triangle 13.Nabla Triangle 14.Rear Land 15.Front Foot	Type	Effective		Influence		Influence Codes 1.Open Space 2.Neighborhood A 3.Topography 4.Size/Shape 5.Access 6.Restriction 7.Corner/Locatio 8.View/Environ 9.Fract Share Acres 30.Rear 20+ 31.Waterfront Rea 32.Open Space 33.RestrictEsm 34.PASTURE 1 35.HORTICULTURAL- 36.Pasture 3 37.Softwood 38.Mixed Wood 39.Hardwood 40.Wasteland 41.CAMP SITE 42.Mobile Home Si 43.Condo Site 44.Site Improve 45.CAMP SITE	
		Frontage	Depth	Factor	Code		
				%			
				%			
				%			
				%			
				%			
				%			
				%			
				%			
Square Foot 16.Regular Lot 17.Secondary Site 18.Secondary Site 19.Condominium 20.Base Homesite		Square Feet					
				%			
				%			
				%			
				%			
				%			
				%			
				%			
				%			
				%			
Fract. Acre 21.HS Size Adj 22.Base Waterfron 23.Deep WF Size A Acres 24.Base Waterfron 25.Shallow WF Siz 26.Base Water Inf 27.Influence W Si 28.Rear Land 1-10 29.Rear Land 11-2		Acreage/Sites					
		20	1.00	100	%	0	
		21	1.00	100	%	0	
		28	1.62	100	%	0	
				%			
				%			
Total Acreage 2.62							

WISCASSET

Map Lot U19-003

Account 1810

Location BATH ROAD

Card 1 Of 1 10/05/2023

Building Style			SF Bsmt Living			Layout		
1.Conv.	5.Colonial	9.Other	Fin Bsmt Grade			1.Typical 4. 7.		
2.Ranch	6.Split	10.Double	HEARTH			2.Inadeq 5. 8.		
3.R Ranch	7.Mod/Cont	11.Multi	Heat Type 100%			3. 6. 9.		
4.Cape	8.Log	12.Cot.	1.HWBB 5.FWA 9.No Heat			Attic		
Dwelling Units			2.HWCI 6.GravWA 10.			1.1/4 Fin 4.Full Fin 7.		
Other Units			3.H Pump 7.Electric 11.			2.1/2 Fin 5.F/Stair 8.		
Stories			4.Steam 8.F/Wall 12.			3.3/4 Fin 6. 9.None		
1.1	4.1.5	7.	Cool Type 0%			Insulation		
2.2	5.1.75	8.	1.Refrig 4.W&C Air 7.			1.Full 4.Minimal 7.		
3.3	6.2.5	9.	2.Evapor 5. 8.			2.Heavy 5.Unknown 8.		
Exterior Walls			3.H Pump 6. 9.None			3.Capped 6. 9.None		
1.CLAP	5.T-111	9.OTHER	Kitchen Style			Unfinished %		
2.WD SH	6.BR/STONE	10.	1.GOOD 4.Obsolete 7.			Grade & Factor		
3.COMP	7.NOV	11.	2.TYPICAL 5. 8.			1.E Grade 4.B Grade 7.AA+ Grad		
4.ASB/ASP	8.AL/VIN	12.	3.OLD TYPE 6. 9.None			2.D Grade 5.A Grade 8.AA++Grad		
Roof Surface			Bath(s) Style			3.C Grade 6.AA Grade 9.Same		
1.Asphalt	4.Composit	7.	1.GOOD 4.Obsolete 7.			SQFT (Footprint)		
2.Slate	5.Wood	8.	2.TYPICAL 5. 8.			Condition		
3.Metal	6.Other	9.	3.Old Type 6. 9.None			1.Poor 4.Avg 7.V G		
SF Masonry Trim			# Rooms			2.Fair 5.Avg+ 8.Exc		
OPEN-3-CUSTOM			# Bedrooms			3.Avg- 6.Good 9.Same		
OPEN-4-CUSTOM			# Full Baths			Phys. % Good		
Year Built			# Half Baths			Funct. % Good		
Year Remodeled			# Addn Fixtures			Functional Code		
Foundation			# Fireplaces			1.Incomp 4.SMALL 7.LAYOUT		
1.Concrete	4.Wood	7.				2.O-Built 5.CDU 8.OTHER		
2.C Block	5.Slab	8.				3.Defmoint 6.STYLE 9.None		
3.Br/Stone	6.Piers	9.				Econ. % Good		
Basement						Economic Code		
1.1/4 Bmt	4.Full Bmt	7.				0.None 3.Services 9.None		
2.1/2 Bmt	5.None	8.				1.Location 4.Traffic 8.		
3.3/4 Bmt	6.	9.None				2.Encroach 8.Other 9.		
Bsmt Gar # Cars						Entrance Code 4 Unoccupied		
Wet Basement						1.Interior 4.Vacant 7.		
1.Dry	4.	7.				2.Refusal 5.Estimate 8.		
2.Damp	5.	8.				3.Informed 6. 9.		
3.Wet	6.	9.				Information Code 5 Estimate		
Date Inspected						1.Owner 4.Agent 7.		
						2.Relative 5.Estimate 8.		
						3.Tenant 6.Other 9.		
Additions, Outbuildings & Improvements								1.ONE STORY FRAM
Type	Year	Units	Grade	Cond	Phys.	Funct.	Sound Value	2.TWO STORY FRAM
					%	%		3.THREE STORY FR
					%	%		4.1 & 1/2 STORY
					%	%		5.1 & 3/4 STORY
					%	%		6.2 & 1/2 STORY
					%	%		21.Open Frame Por
					%	%		22.Encl Frame Por
					%	%		23.Frame Garage
					%	%		24.Frame Shed
					%	%		25.Frame Bay Wind
					%	%		26.1SFr Overhang
					%	%		27.Unfin Basement
					%	%		28.Unfinished Att
					%	%		29.Finished Attic

Map Lot U19-004

Account 2783

Location BATH ROAD

Card 1 Of 1 10/05/2023

MAINE YANKEE ATOMIC ENERGY
321 OLD FERRY ROAD
WISCASSET ME 04578

MAINE YANKEE ATOMIC ENERGY 321 OLD FERRY ROAD WISCASSET ME 04578			Property Data			Assessment Record						
			Neighborhood 200 U.S. RTE 1			Year	Land	Buildings	Exempt	Total		
						2023	233,900	0	0	233,900		
			Tree Growth Year 0									
			FARM LAND YEAR									
OPEN SPACE YEAR												
			Zone/Land Use 19 COMMERCIAL									
			Secondary Zone									
			Topography 2 Rolling									
			1.Level 4.Below St 7.Steep 2.Rolling 5.Low 8.Rough 3.Above St 6.Swampy 9.									
			Utilities									
			1.Public 4.Dr Well 7.Cesspool 2.Water 5.DUG/LAKE 8. 3.Sewer 6.Septic 9.None									
			Street 1 Paved									
			1.Paved 4.Proposed 7. 2.Semi Imp 5.Private 8. 3.Gravel 6.Pub Eas 9.NoStreet									
Inspection Witnessed By:			TREE GROWTH PLAN 0			Land Data						
			CONSERV EASE 0									
			Sale Data			Front Foot	Type	Effective		Influence		Influence Codes
			Sale Date					Frontage	Depth	Factor	Code	
			Price					11.Regular Lot				
Sale Type			12.Delta Triangle							2.Neighborhood A		
X <div>Date</div>			1.Land 4.Mobile 7.			13.Nabla Triangle					3.Topography	
			2.L & B 5.Other 8.			14.Rear Land					4.Size/Shape	
			3.Building 6. 9.			15.Front Foot					5.Access	
			Financing								6.Restriction	
			1.Convent 4.Seller 7. 2.FHA/VA 5.Private 8. 3.Assumed 6.Cash 9.Unknown								7.Corner/Locatio	
Notes: '23 this 5.76 acre parcel has been previously assessed in the total calculation of Maine Yankee's Assessment. Because of ongoing negotiations and lack of agreement on settlement this lot is assessed individually for 2023.			Validity			Square Foot		Square Feet				8.View/Environ
			1.Valid 4.Split 7.Renovate									9.Fract Share
			2.Related 5.Partial 8.Other									Acres
			3.Distress 6.Exempt 9.Foreclose									
			Verified			Fract. Acre	21.HS Size Adj 22.Base Waterfron 23.Deep WF Size A Acres 24.Base Waterfron 25.Shallow WF Siz 26.Base Water Inf 27.Influence W Si 28.Rear Land 1-10 29.Rear Land 11-2	Acreage/Sites				30.Rear 20+
			1.Buyer 4.Agent 7.Family					47	1.00	100 %	0	31.Waterfront Rea
			2.Seller 5.Pub Rec 8.Other					48	1.00	100 %	0	32.Open Space
			3.Lender 6.MLS 9.					50	4.76	100 %	0	33.RestrictEsm
												34.PASTURE 1
												35.HORTICULTURAL-
			Total Acreage		5.76				36.Pasture 3			
									37.Softwood			
									38.Mixed Wood			
									39.Hardwood			
									40.Wasteland			
									41.CAMP SITE			
									42.Mobile Home Si			
									43.Condo Site			
									44.Site Improve			
									45.CAMP SITE			
									46.PAVING/00			
WISCASSET												

Inspection Witnessed By:

X		Date
No./Date	Description	Date Insp.

Notes:
'23 this 5.76 acre parcel has been previously assessed in the total calculation of Maine Yankee's Assessment. Because of ongoing negotiations and lack of agreement on settlement this lot is assessed individually for 2023.

WISCASSET

WISCASSET

Map Lot U19-004

Account 2783

Location BATH ROAD

Card 1 Of 1 10/05/2023

Building Style			SF Bsmt Living			Layout		
1.Conv.	5.Colonial	9.Other	Fin Bsmt Grade			1.Typical 4. 7.		
2.Ranch	6.Split	10.Double	HEARTH			2.Inadeq 5. 8.		
3.R Ranch	7.Mod/Cont	11.Multi	Heat Type 100%			3. 6. 9.		
4.Cape	8.Log	12.Cot.	1.HWBB 5.FWA 9.No Heat			Attic		
Dwelling Units			2.HWCI 6.GravWA 10.			1.1/4 Fin 4.Full Fin 7.		
Other Units			3.H Pump 7.Electric 11.			2.1/2 Fin 5.F/Stair 8.		
Stories			4.Steam 8.F/Wall 12.			3.3/4 Fin 6. 9.None		
1.1	4.1.5	7.	Cool Type 0%			Insulation		
2.2	5.1.75	8.	1.Refrig 4.W&C Air 7.			1.Full 4.Minimal 7.		
3.3	6.2.5	9.	2.Evapor 5. 8.			2.Heavy 5.Unknown 8.		
Exterior Walls			3.H Pump 6. 9.None			3.Capped 6. 9.None		
1.CLAP	5.T-111	9.OTHER	Kitchen Style			Unfinished %		
2.WD SH	6.BR/STONE	10.	1.GOOD 4.Obsolete 7.			Grade & Factor		
3.COMP	7.NOV	11.	2.TYPICAL 5. 8.			1.E Grade 4.B Grade 7.AA+ Grad		
4.ASB/ASP	8.AL/VIN	12.	3.OLD TYPE 6. 9.None			2.D Grade 5.A Grade 8.AA++Grad		
Roof Surface			Bath(s) Style			3.C Grade 6.AA Grade 9.Same		
1.Asphalt	4.Composit	7.	1.GOOD 4.Obsolete 7.			SQFT (Footprint)		
2.Slate	5.Wood	8.	2.TYPICAL 5. 8.			Condition		
3.Metal	6.Other	9.	3.Old Type 6. 9.None			1.Poor 4.Avg 7.V G		
SF Masonry Trim			# Rooms			2.Fair 5.Avg+ 8.Exc		
OPEN-3-CUSTOM			# Bedrooms			3.Avg- 6.Good 9.Same		
OPEN-4-CUSTOM			# Full Baths			Phys. % Good		
Year Built			# Half Baths			Funct. % Good		
Year Remodeled			# Addn Fixtures			Functional Code		
Foundation			# Fireplaces			1.Incomp 4.SMALL 7.LAYOUT		
1.Concrete	4.Wood	7.				2.O-Built 5.CDU 8.OTHER		
2.C Block	5.Slab	8.				3.Defmait 6.STYLE 9.None		
3.Br/Stone	6.Piers	9.				Econ. % Good		
Basement						Economic Code		
1.1/4 Bmt	4.Full Bmt	7.				0.None 3.Services 9.None		
2.1/2 Bmt	5.None	8.				1.Location 4.Traffic 8.		
3.3/4 Bmt	6.	9.None				2.Encroach 8.Other 9.		
Bsmt Gar # Cars						Entrance Code 0		
Wet Basement						1.Interior 4.Vacant 7.		
1.Dry	4.	7.				2.Refusal 5.Estimate 8.		
2.Damp	5.	8.				3.Informed 6. 9.		
3.Wet	6.	9.				Information Code 0		
						1.Owner 4.Agent 7.		
						2.Relative 5.Estimate 8.		
						3.Tenant 6.Other 9.		
Date Inspected								
Additions, Outbuildings & Improvements								1.ONE STORY FRAM
Type	Year	Units	Grade	Cond	Phys.	Funct.	Sound Value	2.TWO STORY FRAM
					%	%		3.THREE STORY FR
					%	%		4.1 & 1/2 STORY
					%	%		5.1 & 3/4 STORY
					%	%		6.2 & 1/2 STORY
					%	%		21.Open Frame Por
					%	%		22.Encl Frame Por
					%	%		23.Frame Garage
					%	%		24.Frame Shed
					%	%		25.Frame Bay Wind
					%	%		26.1SFr Overhang
					%	%		27.Unfin Basement
					%	%		28.Unfinished Att
					%	%		29.Finished Attic

Map Lot U19-004-A

Account 2569

Location BATH ROAD

Card 1 Of 1 10/05/2023

CHEWONKI FOUNDATION, INC.
WISCASSET ME 04578

B4069P238

Inspection Witnessed By:

X		Date
No./Date	Description	Date Insp.

Notes:
2009-Previous Owner: Maine Yankee who retained 5.76 acres and 698.3' frontage. This property now exempt as stated in the deed, non-profit 501 (c) (3) organization.
2015-Changed exemption/use from Charitable to Literary and Scientific as used that way.

WISCASSET

Property Data			Assessment Record				
Neighborhood 200 U.S. RTE 1			Year	Land	Buildings	Exempt	Total
Tree Growth Year 0			2010	82,100	0	82,100	0
FARM LAND YEAR 0			2011	82,100	0	82,100	0
OPEN SPACE YEAR 0			2012	82,100	0	82,100	0
Zone/Land Use 21 RURAL			2013	82,100	0	82,100	0
Secondary Zone 14 S-R			2014	82,100	0	82,100	0
Topography 1 Level			2015	82,100	0	82,100	0
1.Level 4.Below St 7.Steep 2.Rolling 5.Low 8.Rough 3.Above St 6.Swampy 9.			2016	82,100	0	82,100	0
			2017	82,100	0	82,100	0
			2018	82,100	0	82,100	0
Utilities 9 NoWater/NoSewer 1.Public 4.Dr Well 7.Cesspool 2.Water 5.DUG/LAKE 8. 3.Sewer 6.Septic 9.None			2019	82,100	0	82,100	0
			2020	82,100	0	82,100	0
			2021	82,100	0	82,100	0
			2022	82,100	0	82,100	0
Street 1 Paved 1.Paved 4.Proposed 7. 2.Semi Imp 5.Private 8. 3.Gravel 6.Pub Eas 9.NoStreet			2023	102,700	0	102,700	0
Land Data							
Front Foot		Type	Effective		Influence		Influence Codes
			Frontage	Depth	Factor	Code	
11.Regular Lot					%		1.Open Space
12.Delta Triangle					%		2.Neighborhood A
13.Nabla Triangle					%		3.Topography
14.Rear Land					%		4.Size/Shape
15.Front Foot					%		5.Access
					%		6.Restriction
					%		7.Corner/Locatio
					%		8.View/Environ
					%		9.Fract Share
Square Foot		Square Feet					Acres
16.Regular Lot					%		30.Rear 20+
17.Secondary Site					%		31.Waterfront Rea
18.Secondary Site					%		32.Open Space
19.Condominium					%		33.RestrictEsm
20.Base Homesite					%		34.PASTURE 1
					%		35.HORTICULTURAL-
Fract. Acre		Acreage/Sites					36.Pasture 3
21.HS Size Adj		20	1.00	100	%	0	37.Softwood
22.Base Waterfron		21	1.00	100	%	0	38.Mixed Wood
23.Deep WF Size A		28	10.00	100	%	0	39.Hardwood
Acres		29	10.00	100	%	0	40.Wasteland
24.Base Waterfron		30	4.24	100	%	0	41.CAMP SITE
25.Shallow WF Siz					%		42.Mobile Home Si
26.Base Water Inf					%		43.Condo Site
27.Influence W Si					%		44.Site Improve
28.Rear Land 1-10		Total Acreage		25.24			45.CAMP SITE
29.Rear Land 11-2							46.PAVING/00

WISCASSET

Map Lot U19-004-A

Account 2569

Location BATH ROAD

Card 1 Of 1 10/05/2023

Building Style			SF Bsmt Living			Layout		
1.Conv.	5.Colonial	9.Other	Fin Bsmt Grade			1.Typical 4. 7.		
2.Ranch	6.Split	10.Double	HEARTH			2.Inadeq 5. 8.		
3.R Ranch	7.Mod/Cont	11.Multi	Heat Type 100%			3. 6. 9.		
4.Cape	8.Log	12.Cot.	1.HWBB 5.FWA 9.No Heat			Attic		
Dwelling Units			2.HWCI 6.GravWA 10.			1.1/4 Fin 4.Full Fin 7.		
Other Units			3.H Pump 7.Electric 11.			2.1/2 Fin 5.F/Stair 8.		
Stories			4.Steam 8.F/Wall 12.			3.3/4 Fin 6. 9.None		
1.1	4.1.5	7.	Cool Type 0%			Insulation		
2.2	5.1.75	8.	1.Refrig 4.W&C Air 7.			1.Full 4.Minimal 7.		
3.3	6.2.5	9.	2.Evapor 5. 8.			2.Heavy 5.Unknown 8.		
Exterior Walls			3.H Pump 6. 9.None			3.Capped 6. 9.None		
1.CLAP	5.T-111	9.OTHER	Kitchen Style			Unfinished %		
2.WD SH	6.BR/STONE	10.	1.GOOD 4.Obsolete 7.			Grade & Factor		
3.COMP	7.NOV	11.	2.TYPICAL 5. 8.			1.E Grade 4.B Grade 7.AA+ Grad		
4.ASB/ASP	8.AL/VIN	12.	3.OLD TYPE 6. 9.None			2.D Grade 5.A Grade 8.AA++Grad		
Roof Surface			Bath(s) Style			3.C Grade 6.AA Grade 9.Same		
1.Asphalt	4.Composit	7.	1.GOOD 4.Obsolete 7.			SQFT (Footprint)		
2.Slate	5.Wood	8.	2.TYPICAL 5. 8.			Condition		
3.Metal	6.Other	9.	3.Old Type 6. 9.None			1.Poor 4.Avg 7.V G		
SF Masonry Trim			# Rooms			2.Fair 5.Avg+ 8.Exc		
OPEN-3-CUSTOM			# Bedrooms			3.Avg- 6.Good 9.Same		
OPEN-4-CUSTOM			# Full Baths			Phys. % Good		
Year Built			# Half Baths			Funct. % Good		
Year Remodeled			# Addn Fixtures			Functional Code		
Foundation			# Fireplaces			1.Incomp 4.SMALL 7.LAYOUT		
1.Concrete	4.Wood	7.				2.O-Built 5.CDU 8.OTHER		
2.C Block	5.Slab	8.				3.Defmoint 6.STYLE 9.None		
3.Br/Stone	6.Piers	9.				Econ. % Good		
Basement						Economic Code		
1.1/4 Bmt	4.Full Bmt	7.				0.None 3.Services 9.None		
2.1/2 Bmt	5.None	8.				1.Location 4.Traffic 8.		
3.3/4 Bmt	6.	9.None				2.Encroach 8.Other 9.		
Bsmt Gar # Cars						Entrance Code 0		
Wet Basement						1.Interior 4.Vacant 7.		
1.Dry	4.	7.				2.Refusal 5.Estimate 8.		
2.Damp	5.	8.	3.Informed 6. 9.					
3.Wet	6.	9.	Information Code 0					
Date Inspected			1.Owner 4.Agent 7.			2.Relative 5.Estimate 8.		
			2.Relative 5.Estimate 8.			3.Tenant 6.Other 9.		
Additions, Outbuildings & Improvements								1.ONE STORY FRAM
Type	Year	Units	Grade	Cond	Phys.	Funct.	Sound Value	2.TWO STORY FRAM
					%	%		3.THREE STORY FR
					%	%		4.1 & 1/2 STORY
					%	%		5.1 & 3/4 STORY
					%	%		6.2 & 1/2 STORY
					%	%		21.Open Frame Por
					%	%		22.Encl Frame Por
					%	%		23.Frame Garage
					%	%		24.Frame Shed
					%	%		25.Frame Bay Wind
					%	%		26.1SFr Overhang
					%	%		27.Unfin Basement
					%	%		28.Unfinished Att
					%	%		29.Finished Attic

Map Lot U19-005

Account 1811

Location 139 CHEWONKI NECK ROAD

Card 1 Of 1 10/05/2023

RYAN, MICHAEL R
WOOLWICH ME 04579

B2480P339

Inspection Witnessed By:

X

Date

No./Date	Description	Date Insp.

Notes:

WISCASSET

Property Data

Neighborhood	109 SOUTHEAST		
Tree Growth Year	0		
FARM LAND YEAR	0		
OPEN SPACE YEAR	0		
Zone/Land Use	21 RURAL		
Secondary Zone			
Topography	1 Level		
1.Level	4.Below St	7.Steep	
2.Rolling	5.Low	8.Rough	
3.Above St	6.Swampy	9.	
Utilities	4 Drilled Well	6 Septic System	
1.Public	4.Dr Well	7.Cesspool	
2.Water	5.DUG/LAKE	8.	
3.Sewer	6.Septic	9.None	
Street	1 Paved		
1.Paved	4.Proposed	7.	
2.Semi Imp	5.Private	8.	
3.Gravel	6.Pub Eas	9.NoStreet	
TREE GROWTH PLAN	0		
CONSERV EASE	0		
Sale Data			
Sale Date			
Price			
Sale Type			
1.Land	4.Mobile	7.	
2.L & B	5.Other	8.	
3.Building	6.	9.	
Financing			
1.Convent	4.Seller	7.	
2.FHA/VA	5.Private	8.	
3.Assumed	6.Cash	9.Unknown	
Validity			
1.Valid	4.Split	7.Renovate	
2.Related	5.Partial	8.Other	
3.Distress	6.Exempt	9.Foreclose	
Verified			
1.Buyer	4.Agent	7.Family	
2.Seller	5.Pub Rec	8.Other	
3.Lender	6.MLS	9.	

Assessment Record

Year	Land	Buildings	Exempt	Total
2010	142,000	198,100	0	340,100
2011	142,000	198,100	0	340,100
2012	142,000	198,100	0	340,100
2013	142,000	198,100	0	340,100
2014	142,000	198,100	0	340,100
2015	142,000	198,100	0	340,100
2016	142,000	198,100	0	340,100
2017	142,000	198,100	0	340,100
2018	142,000	198,100	0	340,100
2019	142,000	198,100	0	340,100
2020	142,000	198,100	0	340,100
2021	142,000	198,100	0	340,100
2022	142,000	198,100	0	340,100
2023	150,500	216,700	0	367,200

Land Data

Front Foot	Type	Effective		Influence		Influence Codes
		Frontage	Depth	Factor	Code	
11.Regular Lot				%		1.Open Space
12.Delta Triangle				%		2.Neighborhood A
13.Nabla Triangle				%		3.Topography
14.Rear Land				%		4.Size/Shape
15.Front Foot				%		5.Access
				%		6.Restriction
				%		7.Corner/Locatio
				%		8.View/Environ
				%		9.Fract Share
				%		Acres
				%		30.Rear 20+
				%		31.Waterfront Rea
				%		32.Open Space
				%		33.RestrictEsm
				%		34.PASTURE 1
				%		35.HORTICULTURAL-
				%		36.Pasture 3
				%		37.Softwood
				%		38.Mixed Wood
				%		39.Hardwood
				%		40.Wasteland
				%		41.CAMP SITE
				%		42.Mobile Home Si
				%		43.Condo Site
				%		44.Site Improve
				%		45.CAMP SITE
				%		46.PAVING/00
Total Acreage		17.50				

WISCASSET

Map Lot U19-005

Account 1811

Location 139 CHEWONKI NECK ROAD

Card 1 Of 1 10/05/2023

Building Style	SF Bsmt Living	Layout
1.Conv. 5.Colonial 9.Other	Fin Bsmt Grade	1.Typical 4. 7.
2.Ranch 6.Split 10.Double	HEARTH	2.Inadeq 5. 8.
3.R Ranch 7.Mod/Cont 11.Multi	Heat Type 100%	3. 6. 9.
4.Cape 8.Log 12.Cot.	1.HWBB 5.FWA 9.No Heat	Attic
Dwelling Units	2.HWCI 6.GravWA 10.	1.1/4 Fin 4.Full Fin 7.
Other Units	3.H Pump 7.Electric 11.	2.1/2 Fin 5.F/Stair 8.
Stories	4.Steam 8.F/Wall 12.	3.3/4 Fin 6. 9.None
1.1 4.1.5 7.	Cool Type 0%	Insulation
2.2 5.1.75 8.	1.Refrig 4.W&C Air 7.	1.Full 4.Minimal 7.
3.3 6.2.5 9.	2.Evapor 5. 8.	2.Heavy 5.Unknown 8.
Exterior Walls	3.H Pump 6. 9.None	3.Capped 6. 9.None
1.CLAP 5.T-111 9.OTHER	Kitchen Style	Unfinished %
2.WD SH 6.BR/STONE 10.	1.GOOD 4.Obsolete 7.	Grade & Factor
3.COMP 7.NOV 11.	2.TYPICAL 5. 8.	1.E Grade 4.B Grade 7.AA+ Grad
4.ASB/ASP 8.AL/VIN 12.	3.OLD TYPE 6. 9.None	2.D Grade 5.A Grade 8.AA++Grad
Roof Surface	Bath(s) Style	3.C Grade 6.AA Grade 9.Same
1.Asphalt 4.Composit 7.	1.GOOD 4.Obsolete 7.	SQFT (Footprint)
2.Slate 5.Wood 8.	2.TYPICAL 5. 8.	Condition
3.Metal 6.Other 9.	3.Old Type 6. 9.None	1.Poor 4.Avg 7.V G
SF Masonry Trim	# Rooms	2.Fair 5.Avg+ 8.Exc
OPEN-3-CUSTOM	# Bedrooms	3.Avg- 6.Good 9.Same
OPEN-4-CUSTOM	# Full Baths	Phys. % Good
Year Built	# Half Baths	Funct. % Good
Year Remodeled	# Addn Fixtures	Functional Code
Foundation	# Fireplaces	1.Incomp 4.SMALL 7.LAYOUT
1.Concrete 4.Wood 7.		2.O-Built 5.CDU 8.OTHER
2.C Block 5.Slab 8.		3.Defmaint 6.STYLE 9.None
3.Br/Stone 6.Piers 9.		Econ. % Good
Basement		Economic Code
1.1/4 Bmt 4.Full Bmt 7.		0.None 3.Services 9.None
2.1/2 Bmt 5.None 8.		1.Location 4.Traffic 8.
3.3/4 Bmt 6. 9.None		2.Encroach 8.Other 9.
Bsmt Gar # Cars		Entrance Code 3 Information Only
Wet Basement		1.Interior 4.Vacant 7.
1.Dry 4. 7.		2.Refusal 5.Estimate 8.
2.Damp 5. 8.		3.Informed 6. 9.
3.Wet 6. 9.		Information Code 1 Owner
		1.Owner 4.Agent 7.
		2.Relative 5.Estimate 8.
		3.Tenant 6.Other 9.

Date Inspected 3/20/2007

Additions, Outbuildings & Improvements

Type	Year	Units	Grade	Cond	Phys.	Funct.	Sound Value	
248 MAN STEEL.....	1950	8343	2 100	3	0 %	100 %		1.ONE STORY FRAM
248 MAN STEEL.....	0	2987	2 100	3	0 %	100 %		2.TWO STORY FRAM
998 14' Mobile	1978	14x66	2 100	3	0 %	50 %		3.THREE STORY FR
1 ONE STORY	0	64	2 100	3	0 %	100 %		4.1 & 1/2 STORY
22 Encl Frame Porch	0	96	2 100	2	0 %	100 %		5.1 & 3/4 STORY
155 1 ST BARN.....	0	800	2 100	3	0 %	100 %		6.2 & 1/2 STORY
24 Frame Shed	0	800	2 100	3	0 %	100 %		21.Open Frame Por
24 Frame Shed	0	800	2 100	3	0 %	100 %		22.Encl Frame Por
					%	%		23.Frame Garage
					%	%		24.Frame Shed
					%	%		25.Frame Bay Wind
					%	%		26.1SFr Overhang
					%	%		27.Unfin Basement
					%	%		28.Unfinished Att
					%	%		29.Finished Attic

SHED 20X40

BARN 20X40

SHED 20X40

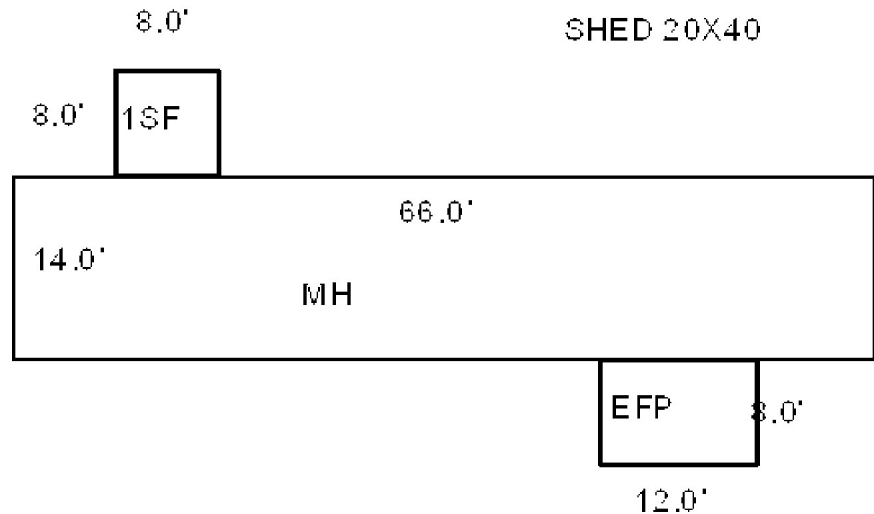

Map Lot		U19-005-A	Account	1812	Location	137 CHEWONKI NECK ROAD			Card	1	Of	1	10/05/2023
RYAN, MICHAEL R WOOLWICH ME 04579 B4761P53					Property Data		Assessment Record						
					Neighborhood 109 SOUTHEAST		Year	Land	Buildings	Exempt	Total		
					Tree Growth Year 0		2010	47,600	101,200	0	148,800		
					FARM LAND YEAR 0		2011	47,600	101,200	0	148,800		
					OPEN SPACE YEAR 0		2012	47,600	35,100	0	82,700		
Previous Owner 137 CHEWONKI NECK ROAD, LLC C/O CHRISTOPHER & JACQUELINE CUNHA 21 LINDEN STREET BATH ME 04530 Sale Date: 2/28/2014					Zone/Land Use 21 RURAL		2013	47,600	35,100	0	82,700		
					Secondary Zone		2014	47,600	8,500	0	56,100		
							2015	47,600	8,500	0	56,100		
					Topography 1 Level		2016	47,600	8,500	0	56,100		
					1.Level 4.Below St 7.Steep 2.Rolling 5.Low 8.Rough 3.Above St 6.Swampy 9.		2017	47,600	8,500	0	56,100		
2018	47,600	8,500	0	56,100									
2019	47,600	8,500	0	56,100									
BATH ME 04530 Sale Date: 8/18/2005					Utilities 4 Drilled Well 6 Septic System		2020	47,600	8,500	0	56,100		
					1.Public 4.Dr Well 7.Cesspool 2.Water 5.DUG/LAKE 8. 3.Sewer 6.Septic 9.None		2021	47,600	8,500	0	56,100		
							2022	47,600	8,500	0	56,100		
							2023	59,400	10,700	0	70,100		
					Previous Owner KEEFE, ANTHONY P. CUNHA JR., CHRISTOPHER V. & JACQUELINE M. C/O CHRISTOPHER & JACQUELINE CUNHA BATH ME 04530 Sale Date: 4/29/2005					Land Data			
Front Foot 11.Regular Lot 12.Delta Triangle 13.Nabla Triangle 14.Rear Land 15.Front Foot		Type	Effective							Influence		Influence Codes 1.Open Space 2.Neighborhood A 3.Topography 4.Size/Shape 5.Access 6.Restriction 7.Corner/Location 8.View/Environment 9.Fract Share Acres 30.Rear 20+ 31.Waterfront Rea 32.Open Space 33.RestrictEsm 34.PASTURE 1 35.HORTICULTURAL- 36.Pasture 3 37.Softwood 38.Mixed Wood 39.Hardwood 40.Wasteland 41.CAMP SITE 42.Mobile Home Si 43.Condo Site 44.Site Improve 45.CAMP SITE 46.PAVING/00	
			Frontage	Depth						Factor	Code		
										%			
										%			
					%								
Inspection Witnessed By: X _____ Date _____					Square Foot 16.Regular Lot 17.Secondary Site 18.Secondary Site 19.Condominium 20.Base Homesite		Square Feet						
								%					
								%					
								%					
								%					
Notes: 2001-JOHN ELLIS GAVE 1/5 INTEREST TO JAMES F. DAVIS PREV. BK2252 PG0133 2001-SOLD TO CHUBBUCK (PREVIOUS BK2582 PG0143 2002-SOLD TO HORNS (PREVIOUS BK2584 PG0303 2004-PREVIOUS OWNER: PAUL HORNS BK2743 PG59 2006-PREVIOUS OWNER: ANTHONY P. KEEFE WHO BOUGHT FOR \$122,500 1/2004 ADDRESS IS 21 LINDEN STREET FOR 2006. NEW OWNER, CUNHA BK3472 PG317 TRANSFERRED TO CORP. WISCASSETT WISCASSETT burned and totally removed April 1, 2012, only foundation remains					Fract. Acre 21.HS Size Adj 22.Base Waterfron 23.Deep WF Size A Acres 24.Base Waterfron 25.Shallow WF Siz 26.Base Water Inf 27.Influence W Si 28.Rear Land 1-10 29.Rear Land 11-2		Acreage/Sites						
							20	1.00	125	%	0		
							21	1.00	100	%	0		
							28	1.50	100	%	0		
									%				
					Verified 5 Public Record								
					1.Buyer 4.Agent 7.Family								
					2.Seller 5.Pub Rec 8.Other								
					3.Lender 6.MLS 9.								

WISCASSET

Map Lot U19-005-A

Account 1812

Location 137 CHEWONKI NECK ROAD

Card 1

Of 1

10/05/2023

Building Style	SF Bsmt Living	Layout
1.Conv. 5.Colonial 9.Other	Fin Bsmt Grade	1.Typical 4. 7.
2.Ranch 6.Split 10.Double	HEARTH	2.Inadeq 5. 8.
3.R Ranch 7.Mod/Cont 11.Multi	Heat Type 100%	3. 6. 9.
4.Cape 8.Log 12.Cot.	1.HWBB 5.FWA 9.No Heat	Attic
Dwelling Units	2.HWCI 6.GravWA 10.	1.1/4 Fin 4.Full Fin 7.
Other Units	3.H Pump 7.Electric 11.	2.1/2 Fin 5.F/Stair 8.
Stories	4.Steam 8.F/Wall 12.	3.3/4 Fin 6. 9.None
1.1 4.1.5 7.	Cool Type 0%	Insulation
2.2 5.1.75 8.	1.Refrig 4.W&C Air 7.	1.Full 4.Minimal 7.
3.3 6.2.5 9.	2.Evapor 5. 8.	2.Heavy 5.Unknown 8.
Exterior Walls	3.H Pump 6. 9.None	3.Capped 6. 9.None
1.CLAP 5.T-111 9.OTHER	Kitchen Style	Unfinished %
2.WD SH 6.BR/STONE 10.	1.GOOD 4.Obsolete 7.	Grade & Factor
3.COMP 7.NOV 11.	2.TYPICAL 5. 8.	1.E Grade 4.B Grade 7.AA+ Grad
4.ASB/ASP 8.AL/VIN 12.	3.OLD TYPE 6. 9.None	2.D Grade 5.A Grade 8.AA++Grad
Roof Surface	Bath(s) Style	3.C Grade 6.AA Grade 9.Same
1.Asphalt 4.Composit 7.	1.GOOD 4.Obsolete 7.	SQFT (Footprint)
2.Slate 5.Wood 8.	2.TYPICAL 5. 8.	Condition
3.Metal 6.Other 9.	3.Old Type 6. 9.None	1.Poor 4.Avg 7.V G
SF Masonry Trim	# Rooms	2.Fair 5.Avg+ 8.Exc
OPEN-3-CUSTOM	# Bedrooms	3.Avg- 6.Good 9.Same
OPEN-4-CUSTOM	# Full Baths	Phys. % Good
Year Built	# Half Baths	Funct. % Good
Year Remodeled	# Addn Fixtures	Functional Code
Foundation	# Fireplaces	1.Incomp 4.SMALL 7.LAYOUT
1.Concrete 4.Wood 7.		2.O-Built 5.CDU 8.OTHER
2.C Block 5.Slab 8.		3.Defmaint 6.STYLE 9.None
3.Br/Stone 6.Piers 9.		Econ. % Good
Basement		Economic Code
1.1/4 Bmt 4.Full Bmt 7.		0.None 3.Services 9.None
2.1/2 Bmt 5.None 8.		1.Location 4.Traffic 8.
3.3/4 Bmt 6. 9.None		2.Encroach 8.Other 9.
Bsmt Gar # Cars		Entrance Code 5 Estimated
Wet Basement		1.Interior 4.Vacant 7.
1.Dry 4. 7.		2.Refusal 5.Estimate 8.
2.Damp 5. 8.		3.Informed 6. 9.
3.Wet 6. 9.		Information Code 5 Estimate
		1.Owner 4.Agent 7.
		2.Relative 5.Estimate 8.
		3.Tenant 6.Other 9.

Date Inspected 3/20/2007

Additions, Outbuildings & Improvements

Type	Year	Units	Grade	Cond	Phys.	Funct.	Sound Value	
103 SLAB.....	2012	4848	2 100	3	0 %	100 %		1.ONE STORY FRAM
					%	%		2.TWO STORY FRAM
					%	%		3.THREE STORY FR
					%	%		4.1 & 1/2 STORY
					%	%		5.1 & 3/4 STORY
					%	%		6.2 & 1/2 STORY
					%	%		21.Open Frame Por
					%	%		22.Encl Frame Por
					%	%		23.Frame Garage
					%	%		24.Frame Shed
					%	%		25.Frame Bay Wind
					%	%		26.1SFr Overhang
					%	%		27.Unfin Basement
					%	%		28.Unfinished Att
					%	%		29.Finished Attic

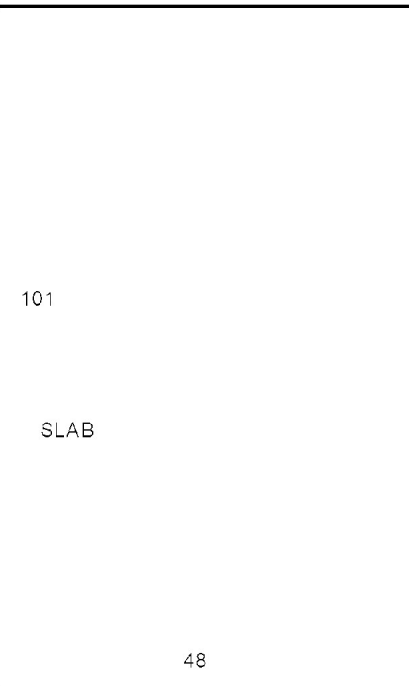

Map Lot U19-006

Account 1813

Location 34 SHADY LANE

Card 1 Of 1 10/05/2023

LORENTSEN, PHILIP
WISCASSET ME 04578

B1089P78

Inspection Witnessed By:

X		Date
No./Date	Description	Date Insp.

Notes:

WISCASSET

Property Data			Assessment Record								
Neighborhood 109 SOUTHEAST			Year	Land		Buildings		Exempt	Total		
			2010	34,800		71,400		16,000	90,200		
Tree Growth Year 0			2011	34,800		71,400		16,000	90,200		
FARM LAND YEAR 0			2012	34,800		71,400		16,000	90,200		
OPEN SPACE YEAR 0			2013	34,800		71,400		16,000	90,200		
Zone/Land Use 21 RURAL			2014	34,800		71,400		16,000	90,200		
Secondary Zone			2015	34,800		71,400		16,000	90,200		
			2016	34,800		71,400		21,000	85,200		
Topography 2 Rolling 3 Above Street			2017	34,800		71,400		26,000	80,200		
1.Level	4.Below St	7.Steep	2018	34,800		71,400		26,000	80,200		
2.Rolling	5.Low	8.Rough	2019	34,800		71,400		26,000	80,200		
3.Above St	6.Swampy	9.	2020	34,800		71,400		31,000	75,200		
Utilities	4 Drilled Well	6 Septic System	2021	34,800		71,400		31,000	75,200		
1.Public	4.Dr Well	7.Cesspool	2022	34,800		71,400		29,760	76,440		
2.Water	5.DUG/LAKE	8.	2023	43,600		89,200		31,000	101,800		
3.Sewer	6.Septic	9.None	Land Data								
Street	1 Paved										
1.Paved	4.Proposed	7.	Front Foot	Type	Effective		Influence		Influence Codes		
2.Semi Imp	5.Private	8.			Frontage	Depth	Factor	Code			
3.Gravel	6.Pub Eas	9.NoStreet					%				
TREE GROWTH PLAN 0					11.Regular Lot			%			1.Open Space
CONSERV EASE 0					12.Delta Triangle			%			2.Neighborhood A
Sale Data					13.Nabla Triangle			%			3.Topography
					14.Rear Land			%			4.Size/Shape
Sale Date			15.Front Foot			%	5.Access				
Price						%	6.Restriction				
Sale Type						%	7.Corner/Locatio				
1.Land	4.Mobile	7.	Square Foot	Square Feet				8.View/Environ			
2.L & B	5.Other	8.					%	9.Fract Share			
3.Building	6.	9.					%	Acres			
Financing				16.Regular Lot			%	30.Rear 20+			
1.Convent	4.Seller	7.		17.Secondary Site			%	31.Waterfront Rea			
2.FHA/VA	5.Private	8.		18.Secondary Site			%	32.Open Space			
3.Assumed	6.Cash	9.Unknown		19.Condominium			%	33.RestrictEsm			
Validity			20.Base Homesite			%	34.PASTURE 1				
1.Valid	4.Split	7.Renovate	Fract. Acre	Acreage/Sites				35.HORTICULTURAL-			
2.Related	5.Partial	8.Other		20	1.00		100	%	0	36.Pasture 3	
3.Distress	6.Exempt	9.Foreclose		21	0.56		100	%	0	37.Softwood	
Verified								%		38.Mixed Wood	
1.Buyer	4.Agent	7.Family						%		39.Hardwood	
2.Seller	5.Pub Rec	8.Other						%		40.Wasteland	
3.Lender	6.MLS	9.						%		41.CAMP SITE	
							%		42.Mobile Home Si		
							%		43.Condo Site		
							%		44.Site Improveme		
							%		45.CAMP SITE		
							%				
							%				
							%				
							%				
							%				
							%				
							%				
							%				
							%				
							%				
							%				
							%				
							%				
							%				
							%				
							%				
							%				
							%				
							%				
							%				
							%				
							%				
							%				
							%				
							%				
							%				
							%				
							%				
							%				
							%				
							%				
							%				
							%				
							%				
							%				
							%				
							%				
							%				
							%				
							%				
							%				
							%				
							%				
							%				
							%				
							%				
							%				
							%				
							%				
							%				
							%				
							%				
							%				
							%				
							%				
							%				
							%				
							%				
							%				
							%				
							%				
							%				
							%				
							%				
							%				

- 1.Open Space
- 2.Neighborhood A
- 3.Topography
- 4.Size/Shape
- 5.Access
- 6.Restriction
- 7.Corner/Locatio
- 8.View/Environ
- 9.Fract Share
- 30.Rear 20+
- 31.Waterfront Rea
- 32.Open Space
- 33.RestrictEsm
- 34.PASTURE 1
- 35.HORTICULTURAL-
- 36.Pasture 3
- 37.Softwood
- 38.Mixed Wood
- 39.Hardwood
- 40.Wasteland
- 41.CAMP SITE
- 42.Mobile Home Si
- 43.Condo Site
- 44.Site Improve
- 45.CAMP SITE
- 46.PAVING/00

WISCASSET										
Map Lot	U19-006	Account	1813	Location	34 SHADY LANE	Card	1	Of	1	10/05/2023

40.0'	16.0'
24.0'	24.0'
1 SF/B	GAR



Map Lot U19-007

Account 1814

Location 38 SHADY LANE

Card 1 Of 1 10/05/2023

EGGEN, KENDRA F
38 SHADY LANE
WISCASSET ME 04578

B5717P251

Previous Owner
MCINTIRE, KAREN E
38 SHADY LANE

WISCASSET ME 04578
Sale Date: 5/26/2021

Previous Owner
PREBLE, LAURA A
38 SHADY LANE

WISCASSET ME 04578
Sale Date: 7/10/2020

Previous Owner
MCINTIRE, KAREN E
1341 POST ROAD

BOWDOINHAM ME 04008
Sale Date: 7/06/2018

Inspection Witnessed By:

X

Date

No./Date	Description	Date Insp.

Notes:

'17 W/ Friend outdoors add wds.

2005-CHANGED ACREAGE FROM .48 TO .52 PER PLANNING BOARD PLAN

2010-Mr. Bancroft died 05/12/2007 leaving property to brother. Brother sold to Acquarius Property Management 10/26/09.

2012-Release deed recorded BK4479 PG295.

WISCASSET**Property Data**Neighborhood **109 SOUTHEAST**Tree Growth Year **0**FARM LAND YEAR **0**OPEN SPACE YEAR **0**Zone/Land Use **21 RURAL**

Secondary Zone

Topography **2 Rolling 3 Above Street**

1.Level 4.Below St 7.Steep
2.Rolling 5.Low 8.Rough
3.Above St 6.Swampy 9.

Utilities **4 Drilled Well 6 Septic System**

1.Public 4.Dr Well 7.Cesspool
2.Water 5.DUG/LAKE 8.
3.Sewer 6.Septic 9.None

Street **1 Paved**

1.Paved 4.Proposed 7.
2.Semi Imp 5.Private 8.
3.Gravel 6.Pub Eas 9.NoStreet

TREE GROWTH PLAN **0**CONSERV EASE **0****Sale Data**Sale Date **5/26/2021**Price **240,000**Sale Type **2 Land & Buildings**

1.Land 4.Mobile 7.
2.L & B 5.Other 8.
3.Building 6. 9.

Financing **9 Unknown**

1.Convent 4.Seller 7.
2.FHA/VA 5.Private 8.
3.Assumed 6.Cash 9.Unknown

Validity **1 Arms Length Sale**

1.Valid 4.Split 7.Renovate
2.Related 5.Partial 8.Other
3.Distress 6.Exempt 9.Foreclose

Verified **5 Public Record**

1.Buyer 4.Agent 7.Family
2.Seller 5.Pub Rec 8.Other
3.Lender 6.MLS 9.

Assessment Record

Year	Land	Buildings	Exempt	Total
2010	34,700	77,800	0	112,500
2011	34,700	77,800	0	112,500
2012	34,700	77,800	0	112,500
2013	34,700	77,800	0	112,500
2014	34,700	77,800	0	112,500
2015	34,700	77,800	0	112,500
2016	34,700	77,800	0	112,500
2017	34,700	80,200	0	114,900
2018	34,700	80,200	6,000	108,900
2019	34,700	80,200	0	114,900
2020	34,700	80,200	0	114,900
2021	34,700	80,200	31,000	83,900
2022	34,700	80,200	0	114,900
2023	43,400	100,300	0	143,700

Land Data

Front Foot	Type	Effective		Influence		Influence Codes
		Frontage	Depth	Factor	Code	
11.Regular Lot				%		1.Open Space
12.Delta Triangle				%		2.Neighborhood A
13.Nabla Triangle				%		3.Topography
14.Rear Land				%		4.Size/Shape
15.Front Foot				%		5.Access
				%		6.Restriction
				%		7.Corner/Locatio
				%		8.View/Environ
				%		9.Fract Share
				%		Acres
				%		30.Rear 20+
				%		31.Waterfront Rea
				%		32.Open Space
				%		33.RestrictEsm
				%		34.PASTURE 1
				%		35.HORTICULTURAL-
				%		36.Pasture 3
				%		37.Softwood
				%		38.Mixed Wood
				%		39.Hardwood
				%		40.Wasteland
				%		41.CAMP SITE
				%		42.Mobile Home Si
				%		43.Condo Site
				%		44.Site Improve
				%		45.CAMP SITE
				%		46.PAVING/00
		Total Acreage		0.52		

Front Foot

11.Regular Lot
12.Delta Triangle
13.Nabla Triangle
14.Rear Land
15.Front Foot

Square Foot

16.Regular Lot
17.Secondary Site
18.Secondary Site
19.Condominium
20.Base Homesite

Fract. Acre

21.HS Size Adj
22.Base Waterfron
23.Deep WF Size A

Acres

24.Base Waterfron
25.Shallow WF Siz
26.Base Water Inf
27.Influence W Si
28.Rear Land 1-10
29.Rear Land 11-2

Type**Effective****Frontage****Depth****Influence****Factor****Code****Square Feet****Acreage/Sites**

20

1.00

100

%

0

21

0.52

100

%

0

Total Acreage 0.52

WISCASSET

Map Lot U19-007

Account 1814

Location 38 SHADY LANE

Card 1

Of 1

10/05/2023

Building Style 2 Ranch	SF Bsmt Living 0	Layout 1 Typical
1.Conv. 5.Colonial 9.Other	Fin Bsmt Grade 0 0	1.Typical 4. 7.
2.Ranch 6.Split 10.Double	HEARTH 0	2.Inadeq 5. 8.
3.R Ranch 7.Mod/Cont 11.Multi	Heat Type 100% 1 Hot Water BB	3. 6. 9.
4.Cape 8.Log 12.Cot.	1.HWBB 5.FWA 9.No Heat	Attic 9 None
Dwelling Units 1	2.HWCI 6.GravWA 10.	1.1/4 Fin 4.Full Fin 7.
Other Units 0	3.H Pump 7.Electric 11.	2.1/2 Fin 5.F/Stair 8.
Stories 1 One Story	4.Steam 8.F/Wall 12.	3.3/4 Fin 6. 9.None
1.1 4.1.5 7.	Cool Type 0% 9 None	Insulation 1 Full
2.2 5.1.75 8.	1.Refrig 4.W&C Air 7.	1.Full 4.Minimal 7.
3.3 6.2.5 9.	2.Evapor 5. 8.	2.Heavy 5.Unknown 8.
Exterior Walls 8 ALUM/VINYL	3.H Pump 6. 9.None	3.Capped 6. 9.None
1.CLAP 5.T-111 9.OTHER	Kitchen Style 2 TYPICAL	Unfinished % 0%
2.WD SH 6.BR/STONE 10.	1.GOOD 4.Obsolete 7.	Grade & Factor 3 Average 100%
3.COMP 7.NOV 11.	2.TYPICAL 5. 8.	1.E Grade 4.B Grade 7.AA+ Grad
4.ASB/ASP 8.AL/VIN 12.	3.OLD TYPE 6. 9.None	2.D Grade 5.A Grade 8.AA++Grad
Roof Surface 1 Asphalt Shingles	Bath(s) Style 2 TYPICAL	3.C Grade 6.AA Grade 9.Same
1.Asphalt 4.Composit 7.	1.GOOD 4.Obsolete 7.	SQFT (Footprint) 960
2.Slate 5.Wood 8.	2.TYPICAL 5. 8.	Condition 3 Below Average
3.Metal 6.Other 9.	3.Old Type 6. 9.None	1.Poor 4.Avg 7.V G
SF Masonry Trim 0	# Rooms 5	2.Fair 5.Avg+ 8.Exc
OPEN-3-CUSTOM 0	# Bedrooms 3	3.Avg- 6.Good 9.Same
OPEN-4-CUSTOM 0	# Full Baths 1	Phys. % Good 0%
Year Built 1975	# Half Baths 0	Funct. % Good 100%
Year Remodeled 0	# Addn Fixtures 0	Functional Code 9 None
Foundation 1 Concrete	# Fireplaces 0	1.Incomp 4.SMALL 7.LAYOUT
1.Concrete 4.Wood 7.		2.O-Built 5.CDU 8.OTHER
2.C Block 5.Slab 8.		3.Defmaint 6.STYLE 9.None
3.Br/Stone 6.Piers 9.		Econ. % Good 100%
Basement 4 Full Basement		Economic Code None
1.1/4 Bmt 4.Full Bmt 7.		0.None 3.Services 9.None
2.1/2 Bmt 5.None 8.		1.Location 4.Traffic 8.
3.3/4 Bmt 6. 9.None		2.Encroach 8.Other 9.
Bsmt Gar # Cars 0		Entrance Code 1 Interior Inspect
Wet Basement 2 Damp Basement		1.Interior 4.Vacant 7.
1.Dry 4. 7.		2.Refusal 5.Estimate 8.
2.Damp 5. 8.		3.Informed 6. 9.
3.Wet 6. 9.		Information Code 1 Owner
		1.Owner 4.Agent 7.
		2.Relative 5.Estimate 8.
		3.Tenant 6.Other 9.

Date Inspected 3/15/2007

Additions, Outbuildings & Improvements

Type	Year	Units	Grade	Cond	Phys.	Funct.	Sound Value	
22 Encl Frame Porch	2002	182	2 100	3	0 %	100 %		1.ONE STORY FRAM
68 Wood Deck	0	64	3 100	4	0 %	100 %		2.TWO STORY FRAM
23 Frame Garage	2002	336	3 100	4	0 %	100 %		3.THREE STORY FR
68 Wood Deck	2016	120	3 100	4	0 %	100 %		4.1 & 1/2 STORY
68 Wood Deck	2016	113	3 100	4	0 %	100 %		5.1 & 3/4 STORY
					%	%		6.2 & 1/2 STORY
					%	%		21.Open Frame Por
					%	%		22.Encl Frame Por
					%	%		23.Frame Garage
					%	%		24.Frame Shed
					%	%		25.Frame Bay Wind
					%	%		26.1SFr Overhang
					%	%		27.Unfin Basement
					%	%		28.Unfinished Att
					%	%		29.Finished Attic



Map Lot U19-008

Account 1815

Location 41 SHADY LANE

Card 1 Of 1 10/05/2023

SHAW, MARITES
SHAW, RICHARD M
41 SHADY LANE
WISCASSET ME 04578

B5797P1

Previous Owner
GOWER, JOAN R

41 SHADY LANE
WISCASSET ME 04578
Sale Date: 10/19/2021

Inspection Witnessed By:

X

Date

No./Date	Description	Date Insp.

Notes:

2006-PER PLANIMETER CHECK CHANGED ACREAGE FROM 3.00 ACRES TO 4.6 ACRES WITH 539' FRONTAGE.
2009-Sold 1.47 acres to daughter who built a new house added on portion of this property. Land retained = 3.13 with 360.88' frontage.

WISCASSET

Property Data

Neighborhood	109 SOUTHEAST	
Tree Growth Year	0	
FARM LAND YEAR	0	
OPEN SPACE YEAR	0	
Zone/Land Use	21 RURAL	
Secondary Zone		
Topography	1 Level	
1.Level	4.Below St	7.Steep
2.Rolling	5.Low	8.Rough
3.Above St	6.Swampy	9.
Utilities	1 All Public	
1.Public	4.Dr Well	7.Cesspool
2.Water	5.DUG/LAKE	8.
3.Sewer	6.Septic	9.None
Street	1 Paved	
1.Paved	4.Proposed	7.
2.Semi Imp	5.Private	8.
3.Gravel	6.Pub Eas	9.NoStreet
TREE GROWTH PLAN	0	
CONSERV EASE	0	
Sale Data		
Sale Date	10/19/2021	
Price	150,000	
Sale Type	2 Land & Buildings	
1.Land	4.Mobile	7.
2.L & B	5.Other	8.
3.Building	6.	9.
Financing	9 Unknown	
1.Convent	4.Seller	7.
2.FHA/VA	5.Private	8.
3.Assumed	6.Cash	9.Unknown
Validity	1 Arms Length Sale	
1.Valid	4.Split	7.Renovate
2.Related	5.Partial	8.Other
3.Distress	6.Exempt	9.Foreclose
Verified	5 Public Record	
1.Buyer	4.Agent	7.Family
2.Seller	5.Pub Rec	8.Other
3.Lender	6.MLS	9.

Assessment Record

Year	Land	Buildings	Exempt	Total
2010	114,000	106,400	16,000	204,400
2011	114,000	106,400	16,000	204,400
2012	114,000	106,400	16,000	204,400
2013	114,000	106,400	16,000	204,400
2014	114,000	106,400	16,000	204,400
2015	114,000	106,400	16,000	204,400
2016	114,000	106,400	21,000	199,400
2017	114,000	106,400	26,000	194,400
2018	114,000	106,400	26,000	194,400
2019	114,000	106,400	26,000	194,400
2020	114,000	106,400	31,000	189,400
2021	114,000	106,400	31,000	189,400
2022	114,000	106,400	0	220,400
2023	142,500	133,000	25,000	250,500

Land Data

Front Foot	Type	Effective		Influence		Influence Codes
		Frontage	Depth	Factor	Code	
11.Regular Lot				%		1.Open Space
12.Delta Triangle				%		2.Neighborhood A
13.Nabla Triangle				%		3.Topography
14.Rear Land				%		4.Size/Shape
15.Front Foot				%		5.Access
				%		6.Restriction
				%		7.Corner/Locatio
				%		8.View/Environ
				%		9.Fract Share
				%		Acres
				%		30.Rear 20+
				%		31.Waterfront Rea
				%		32.Open Space
				%		33.RestrictEsm
				%		34.PASTURE 1
				%		35.HORTICULTURAL-
				%		36.Pasture 3
				%		37.Softwood
				%		38.Mixed Wood
				%		39.Hardwood
				%		40.Wasteland
				%		41.CAMP SITE
				%		42.Mobile Home Si
				%		43.Condo Site
				%		44.Site Improve
				%		45.CAMP SITE
				%		46.PAVING/00
Total Acreage		3.13				

WISCASSET

Map Lot U19-008

Account 1815

Location 41 SHADY LANE

Card 1

Of 1

10/05/2023

Building Style 2 Ranch	SF Bsmt Living 0	Layout 1 Typical
1.Conv. 5.Colonial 9.Other	Fin Bsmt Grade 0 0	1.Typical 4. 7.
2.Ranch 6.Split 10.Double	HEARTH 0	2.Inadeq 5. 8.
3.R Ranch 7.Mod/Cont 11.Multi	Heat Type 100% 1 Hot Water BB	3. 6. 9.
4.Cape 8.Log 12.Cot.	1.HWBB 5.FWA 9.No Heat	Attic 9 None
Dwelling Units 1	2.HWCI 6.GravWA 10.	1.1/4 Fin 4.Full Fin 7.
Other Units 0	3.H Pump 7.Electric 11.	2.1/2 Fin 5.F/Stair 8.
Stories 1 One Story	4.Steam 8.F/Wall 12.	3.3/4 Fin 6. 9.None
1.1 4.1.5 7.	Cool Type 0% 9 None	Insulation 1 Full
2.2 5.1.75 8.	1.Refrig 4.W&C Air 7.	1.Full 4.Minimal 7.
3.3 6.2.5 9.	2.Evapor 5. 8.	2.Heavy 5.Unknown 8.
Exterior Walls 8 ALUM/VINYL	3.H Pump 6. 9.None	3.Capped 6. 9.None
1.CLAP 5.T-111 9.OTHER	Kitchen Style 2 TYPICAL	Unfinished % 0%
2.WD SH 6.BR/STONE 10.	1.GOOD 4.Obsolete 7.	Grade & Factor 3 Average 100%
3.COMP 7.NOV 11.	2.TYPICAL 5. 8.	1.E Grade 4.B Grade 7.AA+ Grad
4.ASB/ASP 8.AL/VIN 12.	3.OLD TYPE 6. 9.None	2.D Grade 5.A Grade 8.AA++Grad
Roof Surface 1 Asphalt Shingles	Bath(s) Style 2 TYPICAL	3.C Grade 6.AA Grade 9.Same
1.Asphalt 4.Composit 7.	1.GOOD 4.Obsolete 7.	SQFT (Footprint) 912
2.Slate 5.Wood 8.	2.TYPICAL 5. 8.	Condition 4 Average
3.Metal 6.Other 9.	3.Old Type 6. 9.None	1.Poor 4.Avg 7.V G
SF Masonry Trim 0	# Rooms 5	2.Fair 5.Avg+ 8.Exc
OPEN-3-CUSTOM 0	# Bedrooms 2	3.Avg- 6.Good 9.Same
OPEN-4-CUSTOM 0	# Full Baths 1	Phys. % Good 0%
Year Built 1970	# Half Baths 0	Funct. % Good 100%
Year Remodeled 0	# Addn Fixtures 0	Functional Code 9 None
Foundation 1 Concrete	# Fireplaces 1	1.Incomp 4.SMALL 7.LAYOUT
1.Concrete 4.Wood 7.		2.O-Built 5.CDU 8.OTHER
2.C Block 5.Slab 8.		3.Defmaint 6.STYLE 9.None
3.Br/Stone 6.Piers 9.		Econ. % Good 100%
Basement 4 Full Basement		Economic Code None
1.1/4 Bmt 4.Full Bmt 7.		0.None 3.Services 9.None
2.1/2 Bmt 5.None 8.		1.Location 4.Traffic 8.
3.3/4 Bmt 6. 9.None		2.Encroach 8.Other 9.
Bsmt Gar # Cars 0		Entrance Code 3 Information Only
Wet Basement 3 Wet Basement		1.Interior 4.Vacant 7.
1.Dry 4. 7.		2.Refusal 5.Estimate 8.
2.Damp 5. 8.		3.Informed 6. 9.
3.Wet 6. 9.		Information Code 2 Relative
		1.Owner 4.Agent 7.
		2.Relative 5.Estimate 8.
		3.Tenant 6.Other 9.

Date Inspected 12/08/2006

Additions, Outbuildings & Improvements

Type	Year	Units	Grade	Cond	Phys.	Funct.	Sound Value	
22 Encl Frame Porch	0	236	0 0	0	0 %	0 %		1.ONE STORY FRAM
91 1S AD/GAR.....	0	576	3 100	4	0 %	100 %		2.TWO STORY FRAM
68 Wood Deck	0	36	1 100	1	0 %	100 %		3.THREE STORY FR
71 CARPORT.....	0	336	2 100	1	0 %	100 %		4.1 & 1/2 STORY
					%	%		5.1 & 3/4 STORY
					%	%		6.2 & 1/2 STORY
					%	%		21.Open Frame Por
					%	%		22.Encl Frame Por
					%	%		23.Frame Garage
					%	%		24.Frame Shed
					%	%		25.Frame Bay Wind
					%	%		26.1SFr Overhang
					%	%		27.Unfin Basement
					%	%		28.Unfinished Att
					%	%		29.Finished Attic

POLE SHED 13X26

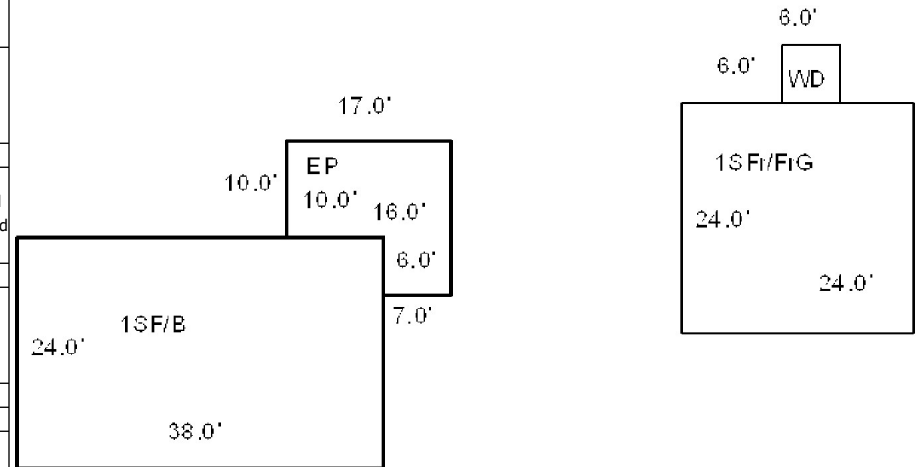

Map Lot U19-008-A			Account 1816			Location 59 SHADY LANE			Card 1		Of 1		10/05/2023							
BERRY, LAURIE C WISCASSET ME 04578						Property Data			Assessment Record											
						Neighborhood 109 SOUTHEAST			Year	Land	Buildings	Exempt	Total							
						Tree Growth Year 0			2010	41,900	153,600	10,000	185,500							
						FARM LAND YEAR 0			2011	41,900	153,600	10,000	185,500							
						OPEN SPACE YEAR 0			2012	41,900	153,600	10,000	185,500							
B3007P150						Zone/Land Use 21 RURAL			2013	41,900	153,600	10,000	185,500							
Previous Owner BERRY, LAWRENCE F. BERRY, LAURIE C.						Secondary Zone			2014	41,900	153,600	10,000	185,500							
									2015	41,900	153,600	10,000	185,500							
WISCASSET ME 04578						Topography 4 Below Street			2016	41,900	153,600	15,000	180,500							
									2017	45,200	153,600	20,000	178,800							
						1.Level 4.Below St 7.Steep 2.Rolling 5.Low 8.Rough 3.Above St 6.Swampy 9.			2018	45,200	153,600	20,000	178,800							
						Utilities 4 Drilled Well 6 Septic System			2019	45,200	153,600	20,000	178,800							
						1.Public 4.Dr Well 7.Cesspool 2.Water 5.DUG/LAKE 8. 3.Sewer 6.Septic 9.None			2020	45,200	153,600	25,000	173,800							
									2021	45,200	153,600	25,000	173,800							
						Street 1 Paved			2022	45,200	153,600	24,000	174,800							
						1.Paved 4.Proposed 7. 2.Semi Imp 5.Private 8. 3.Gravel 6.Pub Eas 9.NoStreet			2023	53,100	191,900	25,000	220,000							
						TREE GROWTH PLAN 0														
						CONSERV EASE 0														
Inspection Witnessed By:						Sale Data			Land Data											
X						Sale Date			Front Foot		Type		Effective		Influence		Influence Codes			
						Price							Frontage		Depth				Factor	
Date						Sale Type							Square Feet							
No./Date						1.Land 4.Mobile 7. 2.L & B 5.Other 8. 3.Building 6. 9.							Square Foot							
						Financing			16.Regular Lot						1.Open Space					
						1.Convent 4.Seller 7. 2.FHA/VA 5.Private 8. 3.Assumed 6.Cash 9.Unknown			17.Secondary Site						2.Neighborhood A					
						Validity			18.Secondary Site						3.Topography					
						1.Valid 4.Split 7.Renovate 2.Related 5.Partial 8.Other 3.Distress 6.Exempt 9.Foreclose			19.Condominium						4.Size/Shape					
						Verified			20.Base Homesite						5.Access					
Notes:						1.Buyer 4.Agent 7.Family 2.Seller 5.Pub Rec 8.Other 3.Lender 6.MLS 9.			Fract. Acre						6.Restriction					
									21.HS Size Adj						7.Cornet/Locatio					
									22.Base Waterfron						8.View/Environ					
									23.Deep WF Size A						9.Fract Share					
									Acres						Acres					
									24.Base Waterfron						30.Rear 20+					
									25.Shallow WF Siz						31.Waterfront Rea					
									26.Base Water Inf						32.Open Space					
									27.Influence W Si						33.RestrictEsm					
									28.Rear Land 1-10						34.PASTURE 1					
									29.Rear Land 11-2						35.HORTICULTURAL-					
											Acreege/Sites				36.Pasture 3					
									20		1.00		100 % 0		37.Softwood					
									21		1.00		100 % 0		38.Mixed Wood					
									28		3.10		100 % 0		39.Hardwood					
															40.Wasteland					
															41.CAMP SITE					
															42.Mobile Home Si					
															43.Condo Site					
															44.Site Improve					
															45.CAMP SITE					
															46.PAVING/00					
															</					

WISCASSET

Map Lot U19-008-A

Account 1816

Location 59 SHADY LANE

Card 1

Of 1

10/05/2023

Building Style 5 Colonial	SF Bsmt Living 0	Layout 1 Typical
1.Conv. 5.Colonial 9.Other	Fin Bsmt Grade 0 0	1.Typical 4. 7.
2.Ranch 6.Split 10.Double	HEARTH 0	2.Inadeq 5. 8.
3.R Ranch 7.Mod/Cont 11.Multi	Heat Type 100% 1 Hot Water BB	3. 6. 9.
4.Cape 8.Log 12.Cot.	1.HWBB 5.FWA 9.No Heat	Attic 9 None
Dwelling Units 1	2.HWCI 6.GravWA 10.	1.1/4 Fin 4.Full Fin 7.
Other Units 0	3.H Pump 7.Electric 11.	2.1/2 Fin 5.F/Stair 8.
Stories 5 One & 3/4 Story	4.Steam 8.F/Wall 12.	3.3/4 Fin 6. 9.None
1.1 4.1.5 7.	Cool Type 0% 9 None	Insulation 1 Full
2.2 5.1.75 8.	1.Refrig 4.W&C Air 7.	1.Full 4.Minimal 7.
3.3 6.2.5 9.	2.Evapor 5. 8.	2.Heavy 5.Unknown 8.
Exterior Walls 1 CLAPBOARD	3.H Pump 6. 9.None	3.Capped 6. 9.None
1.CLAP 5.T-111 9.OTHER	Kitchen Style 2 TYPICAL	Unfinished % 0%
2.WD SH 6.BR/STONE 10.	1.GOOD 4.Obsolete 7.	Grade & Factor 4 Good 95%
3.COMP 7.NOV 11.	2.TYPICAL 5. 8.	1.E Grade 4.B Grade 7.AA+ Grad
4.ASB/ASP 8.AL/VIN 12.	3.OLD TYPE 6. 9.None	2.D Grade 5.A Grade 8.AA++Grad
Roof Surface 1 Asphalt Shingles	Bath(s) Style 2 TYPICAL	3.C Grade 6.AA Grade 9.Same
1.Asphalt 4.Composit 7.	1.GOOD 4.Obsolete 7.	SQFT (Footprint) 825
2.Slate 5.Wood 8.	2.TYPICAL 5. 8.	Condition 4 Average
3.Metal 6.Other 9.	3.Old Type 6. 9.None	1.Poor 4.Avg 7.V G
SF Masonry Trim 0	# Rooms 5	2.Fair 5.Avg+ 8.Exc
OPEN-3-CUSTOM 0	# Bedrooms 3	3.Avg- 6.Good 9.Same
OPEN-4-CUSTOM 0	# Full Baths 1	Phys. % Good 0%
Year Built 1985	# Half Baths 1	Funct. % Good 95%
Year Remodeled 0	# Addn Fixtures 0	Functional Code 9 None
Foundation 1 Concrete	# Fireplaces 1	1.Incomp 4.SMALL 7.LAYOUT
1.Concrete 4.Wood 7.		2.O-Built 5.CDU 8.OTHER
2.C Block 5.Slab 8.		3.Defmaint 6.STYLE 9.None
3.Br/Stone 6.Piers 9.		Econ. % Good 100%
Basement 4 Full Basement		Economic Code None
1.1/4 Bmt 4.Full Bmt 7.		0.None 3.Services 9.None
2.1/2 Bmt 5.None 8.		1.Location 4.Traffic 8.
3.3/4 Bmt 6. 9.None		2.Encroach 8.Other 9.
Bsmt Gar # Cars 0		Entrance Code 1 Interior Inspect
Wet Basement 1 Dry Basement		1.Interior 4.Vacant 7.
1.Dry 4. 7.		2.Refusal 5.Estimate 8.
2.Damp 5. 8.		3.Informed 6. 9.
3.Wet 6. 9.		Information Code 1 Owner
		1.Owner 4.Agent 7.
		2.Relative 5.Estimate 8.
		3.Tenant 6.Other 9.

Date Inspected 3/22/2007

Additions, Outbuildings & Improvements

Type	Year	Units	Grade	Cond	Phys.	Funct.	Sound Value	
23 Frame Garage	1980	384	3 100	4	0 %	100 %		1.ONE STORY FRAM
85 1.75 ST SHED....	1997	320	3 100	4	0 %	80 %		2.TWO STORY FRAM
24 Frame Shed	0				%	%	100	3.THREE STORY FR
50 CAPPED	1989	320	3 100	3	0 %	100 %		4.1 & 1/2 STORY
33 Masonry Garage	1999	1080	3 100	4	0 %	100 %		5.1 & 3/4 STORY
21 Open Frame	1999	84	3 100	4	0 %	100 %		6.2 & 1/2 STORY
					%	%		21.Open Frame Por
					%	%		22.Encl Frame Por
					%	%		23.Frame Garage
					%	%		24.Frame Shed
					%	%		25.Frame Bay Wind
					%	%		26.1SFr Overhang
					%	%		27.Unfin Basement
					%	%		28.Unfinished Att
					%	%		29.Finished Attic

SHED 8X12

GARAGE 16X24

1.75S SHED 16X20

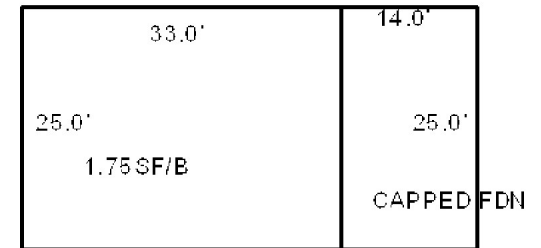

SEPARATE 325X40 CAPPED FOUNDATION



Map Lot		U19-008-B	Account	2570	Location	39 SHADY LANE		Card	1	Of	1	10/05/2023
HANNA, BLAINE G HANNA, GLORIA J 39 SHADY LANE WISCASSET ME 04578 B5460P270 Previous Owner MEEHAN, TERRANCE J J/T MEEHAN, THERESA M WISCASSET ME 04578 Sale Date: 11/21/2019 Previous Owner GOWER, CYNTHIA L. 39 SHADY LANE WISCASSET ME 04578 Sale Date: 10/18/2013					Property Data		Assessment Record					
					Neighborhood 109 SOUTHEAST		Year	Land	Buildings	Exempt	Total	
					Tree Growth Year 0		2010	37,200	106,600	10,000	133,800	
					FARM LAND YEAR 0		2011	37,200	106,600	10,000	133,800	
					OPEN SPACE YEAR 0		2012	37,200	106,600	10,000	133,800	
Previous Owner MEEHAN, TERRANCE J J/T MEEHAN, THERESA M WISCASSET ME 04578 Sale Date: 11/21/2019 Previous Owner GOWER, CYNTHIA L. 39 SHADY LANE WISCASSET ME 04578 Sale Date: 10/18/2013					Zone/Land Use 21 RURAL		2013	37,200	106,600	10,000	133,800	
					Secondary Zone		2014	37,200	106,600	10,000	133,800	
							2015	37,200	106,600	10,000	133,800	
					Topography 1 Level		2016	37,200	106,600	15,000	128,800	
					1.Level 4.Below St 7.Steep 2.Rolling 5.Low 8.Rough 3.Above St 6.Swampy 9.		2017	37,200	106,600	20,000	123,800	
							2018	37,200	106,600	20,000	123,800	
							2019	37,200	106,600	20,000	123,800	
					Utilities 1 All Public		2020	37,200	106,600	0	143,800	
					1.Public 4.Dr Well 7.Cesspool 2.Water 5.DUG/LAKE 8. 3.Sewer 6.Septic 9.None		2021	37,200	106,600	31,000	112,800	
							2022	37,200	121,800	29,760	129,240	
2023	46,600	152,200	31,000	167,800								
Inspection Witnessed By: X Date					Land Data							
					Front Foot 11.Regular Lot 12.Delta Triangle 13.Nabla Triangle 14.Rear Land 15.Front Foot		Type	Effective		Influence		Influence Codes 1.Open Space 2.Neighborhood A 3.Topography 4.Size/Shape 5.Access 6.Restriction 7.Corner/Locatio 8.View/Environ 9.Fract Share Acres 30.Rear 20+ 31.Waterfront Rea 32.Open Space 33.RestrictEsm 34.PASTURE 1 35.HORTICULTURAL- 36.Pasture 3 37.Softwood 38.Mixed Wood 39.Hardwood 40.Wasteland 41.CAMP SITE 42.Mobile Home Si 43.Condo Site 44.Site Improveveme 45.CAMP SITE 46.PAVING/00
								Frontage	Depth	Factor	Code	
										%		
										%		
										%		
										%		
										%		
					Square Foot 16.Regular Lot 17.Secondary Site 18.Secondary Site 19.Condominium 20.Base Homesite		Square Feet					
									%			
		%										
Notes: 7/19/22 NAH ADD NEW GAR 6/15/21 DRIVEBY JUST A SLAB, EST AFTER 4/1 178.12' FRONTAGE 2014-Previous owner: Cynthia L. Gower BK4065 PG249.					Fract. Acre 21.HS Size Adj 22.Base Waterfron 23.Deep WF Size A Acres 24.Base Waterfron 25.Shallow WF Siz 26.Base Water Inf 27.Influence W Si 28.Rear Land 1-10 29.Rear Land 11-2		Acreage/Sites					
							20	1.00	100	%	0	
							21	1.00	100	%	0	
					Validity 1 Arms Length Sale 1.Valid 4.Split 7.Renovate 2.Related 5.Partial 8.Other 3.Distress 6.Exempt 9.Foreclose		28	0.47	100	%	0	
									%			
									%			
					Verified 5 Public Record 1.Buyer 4.Agent 7.Family 2.Seller 5.Pub Rec 8.Other 3.Lender 6.MLS 9.							
									%			
									%			
					WISCASSET							Total Acreage

WISCASSET

Map Lot U19-008-B

Account 2570

Location 39 SHADY LANE

Card 1

Of 1

10/05/2023

Building Style 2 Ranch	SF Bsmt Living 0	Layout 1 Typical
1.Conv. 5.Colonial 9.Other	Fin Bsmt Grade 0 0	1.Typical 4. 7.
2.Ranch 6.Split 10.Double	HEARTH 0	2.Inadeq 5. 8.
3.R Ranch 7.Mod/Cont 11.Multi	Heat Type 100% 5 Forced Warm Air	3. 6. 9.
4.Cape 8.Log 12.Cot.	1.HWBB 5.FWA 9.No Heat	Attic 9 None
Dwelling Units 1	2.HWCI 6.GravWA 10.	1.1/4 Fin 4.Full Fin 7.
Other Units 0	3.H Pump 7.Electric 11.	2.1/2 Fin 5.F/Stair 8.
Stories 1 One Story	4.Steam 8.F/Wall 12.	3.3/4 Fin 6. 9.None
1.1 4.1.5 7.	Cool Type 0% 9 None	Insulation 1 Full
2.2 5.1.75 8.	1.Refrig 4.W&C Air 7.	1.Full 4.Minimal 7.
3.3 6.2.5 9.	2.Evapor 5. 8.	2.Heavy 5.Unknown 8.
Exterior Walls 8 ALUM/VINYL	3.H Pump 6. 9.None	3.Capped 6. 9.None
1.CLAP 5.T-111 9.OTHER	Kitchen Style 2 TYPICAL	Unfinished % 0%
2.WD SH 6.BR/STONE 10.	1.GOOD 4.Obsolete 7.	Grade & Factor 3 Average 100%
3.COMP 7.NOV 11.	2.TYPICAL 5. 8.	1.E Grade 4.B Grade 7.AA+ Grad
4.ASB/ASP 8.AL/VIN 12.	3.OLD TYPE 6. 9.None	2.D Grade 5.A Grade 8.AA++Grad
Roof Surface 1 Asphalt Shingles	Bath(s) Style 2 TYPICAL	3.C Grade 6.AA Grade 9.Same
1.Asphalt 4.Composit 7.	1.GOOD 4.Obsolete 7.	SQFT (Footprint) 1350
2.Slate 5.Wood 8.	2.TYPICAL 5. 8.	Condition 4 Average
3.Metal 6.Other 9.	3.Old Type 6. 9.None	1.Poor 4.Avg 7.V G
SF Masonry Trim 0	# Rooms 5	2.Fair 5.Avg+ 8.Exc
OPEN-3-CUSTOM 0	# Bedrooms 3	3.Avg- 6.Good 9.Same
OPEN-4-CUSTOM 0	# Full Baths 2	Phys. % Good 0%
Year Built 2009	# Half Baths 0	Funct. % Good 100%
Year Remodeled 0	# Addn Fixtures 0	Functional Code 9 None
Foundation 5 Concrete Slab	# Fireplaces 0	1.Incomp 4.SMALL 7.LAYOUT
1.Concrete 4.Wood 7.		2.O-Built 5.CDU 8.OTHER
2.C Block 5.Slab 8.		3.Defmaint 6.STYLE 9.None
3.Br/Stone 6.Piers 9.		Econ. % Good 100%
Basement 9 No Basement		Economic Code None
1.1/4 Bmt 4.Full Bmt 7.		0.None 3.Services 9.None
2.1/2 Bmt 5.None 8.		1.Location 4.Traffic 8.
3.3/4 Bmt 6. 9.None		2.Encroach 8.Other 9.
Bsmt Gar # Cars 0		Entrance Code 1 Interior Inspect
Wet Basement 9 No Basement		1.Interior 4.Vacant 7.
1.Dry 4. 7.		2.Refusal 5.Estimate 8.
2.Damp 5. 8.		3.Informed 6. 9.
3.Wet 6. 9.		Information Code 0
		1.Owner 4.Agent 7.
		2.Relative 5.Estimate 8.
		3.Tenant 6.Other 9.

Date Inspected 6/01/2010

Additions, Outbuildings & Improvements

Type	Year	Units	Grade	Cond	Phys.	Funct.	Sound Value	
24 Frame Shed	2009	80	3 100	4	0 %	100 %		1.ONE STORY FRAM
23 Frame Garage	2021	576	3 100	4	0 %	100 %		2.TWO STORY FRAM
					%	%		3.THREE STORY FR
					%	%		4.1 & 1/2 STORY
					%	%		5.1 & 3/4 STORY
					%	%		6.2 & 1/2 STORY
					%	%		21.Open Frame Por
					%	%		22.Encl Frame Por
					%	%		23.Frame Garage
					%	%		24.Frame Shed
					%	%		25.Frame Bay Wind
					%	%		26.1SFr Overhang
					%	%		27.Unfin Basement
					%	%		28.Unfinished Att
					%	%		29.Finished Attic

SHED

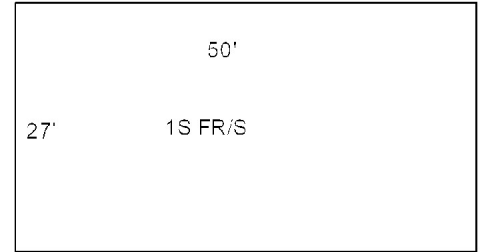
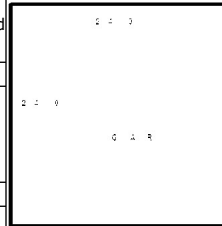

Map Lot

U19-008-C

Account

2788

Location

SHADY LANE

Card

1

Of

1

10/05/2023

STAYCATIONLAND, LLC

114 MASSACHUSETTS AVE

PORTLAND ME 04102

Property Data

Neighborhood

109 SOUTHEAST

Year

2023

Land

42,700

Buildings

0

Exempt

0

Total

42,700

Tree Growth Year

0

FARM LAND YEAR

OPEN SPACE YEAR

Zone/Land Use

21 RURAL

Secondary Zone

Topography

2 Rolling

1.Level

4.Below St

7.Steep

2.Rolling

5.Low

8.Rough

3.Above St

6.Swampy

9.

Utilities

1.Public

4.Dr Well

7.Cesspool

2.Water

5.DUG/LAKE

8.

3.Sewer

6.Septic

9.None

Street

1 Paved

1.Paved

4.Proposed

7.

2.Semi Imp

5.Private

8.

3.Gravel

6.Pub Eas

9.NoStreet

TREE GROWTH PLAN

0

CONSERV EASE

0

Sale Data

Sale Date

3/06/2023

Price

20,000

Sale Type

1 Land Only

1.Land

4.Mobile

7.

2.L & B

5.Other

8.

3.Building

6.

9.

Financing

9 Unknown

1.Convent

4.Seller

7.

2.FHA/VA

5.Private

8.

3.Assumed

6.Cash

9.Unknown

Validity

8 Other Non Valid

1.Valid

4.Split

7.Renovate

2.Related

5.Partial

8.Other

3.Distress

6.Exempt

9.Foreclose

Verified

5 Public Record

1.Buyer

4.Agent

7.Family

2.Seller

5.Pub Rec

8.Other

3.Lender

6.MLS

9.

Assessment Record

Land Data

Front Foot

11.Regular Lot

12.Delta Triangle

13.Nabla Triangle

14.Rear Land

15.Front Foot

Square Foot

16.Regular Lot

17.Secondary Site

18.Secondary Site

19.Condominium

20.Base Homesite

Fract. Acre

21.HS Size Adj

22.Base Waterfron

23.Deep WF Size A

Acres

24.Base Waterfron

25.Shallow WF Siz

26.Base Water Inf

27.Influence W Si

28.Rear Land 1-10

29.Rear Land 11-2

Type

Effective

Frontage

Depth

Influence

Factor

Code

Influence Codes

1.Open Space

2.Neighborhood A

3.Topography

4.Size/Shape

5.Access

6.Restriction

7.Corner/Locatio

8.View/Environ

9.Fract Share

Acres

30.Rear 20+

31.Waterfront Rea

32.Open Space

33.RestrictEsm

34.PASTURE 1

35.HORTICULTURAL-

36.Pasture 3

37.Softwood

38.Mixed Wood

39.Hardwood

40.Wasteland

41.CAMP SITE

42.Mobile Home Si

43.Condo Site

44.Site Improve

45.CAMP SITE

46.PAVING/00

Square Feet

Total Acreage

0.35

Inspection Witnessed By:

Date

No./Date

Description

Date Insp.

Notes:

'23 1.35 ACRES FROM LOT 8-A

WISCASSET

WISCASSET

Map Lot U19-008-C

Account 2788

Location SHADY LANE

Card 1 Of 1 10/05/2023

Building Style			SF Bsmt Living			Layout		
1.Conv.	5.Colonial	9.Other	Fin Bsmt Grade			1.Typical 4. 7.		
2.Ranch	6.Split	10.Double	HEARTH			2.Inadeq 5. 8.		
3.R Ranch	7.Mod/Cont	11.Multi	Heat Type 100%			3. 6. 9.		
4.Cape	8.Log	12.Cot.	1.HWBB 5.FWA 9.No Heat			Attic		
Dwelling Units			2.HWCI 6.GravWA 10.			1.1/4 Fin 4.Full Fin 7.		
Other Units			3.H Pump 7.Electric 11.			2.1/2 Fin 5.F/Stair 8.		
Stories			4.Steam 8.F/Wall 12.			3.3/4 Fin 6. 9.None		
1.1	4.1.5	7.	Cool Type 0%			Insulation		
2.2	5.1.75	8.	1.Refrig 4.W&C Air 7.			1.Full 4.Minimal 7.		
3.3	6.2.5	9.	2.Evapor 5. 8.			2.Heavy 5.Unknown 8.		
Exterior Walls			3.H Pump 6. 9.None			3.Capped 6. 9.None		
1.CLAP	5.T-111	9.OTHER	Kitchen Style			Unfinished %		
2.WD SH	6.BR/STONE	10.	1.GOOD 4.Obsolete 7.			Grade & Factor		
3.COMP	7.NOV	11.	2.TYPICAL 5. 8.			1.E Grade 4.B Grade 7.AA+ Grad		
4.ASB/ASP	8.AL/VIN	12.	3.OLD TYPE 6. 9.None			2.D Grade 5.A Grade 8.AA++Grad		
Roof Surface			Bath(s) Style			3.C Grade 6.AA Grade 9.Same		
1.Asphalt	4.Composit	7.	1.GOOD 4.Obsolete 7.			SQFT (Footprint)		
2.Slate	5.Wood	8.	2.TYPICAL 5. 8.			Condition		
3.Metal	6.Other	9.	3.Old Type 6. 9.None			1.Poor 4.Avg 7.V G		
SF Masonry Trim			# Rooms			2.Fair 5.Avg+ 8.Exc		
OPEN-3-CUSTOM			# Bedrooms			3.Avg- 6.Good 9.Same		
OPEN-4-CUSTOM			# Full Baths			Phys. % Good		
Year Built			# Half Baths			Funct. % Good		
Year Remodeled			# Addn Fixtures			Functional Code		
Foundation			# Fireplaces			1.Incomp 4.SMALL 7.LAYOUT		
1.Concrete	4.Wood	7.				2.O-Built 5.CDU 8.OTHER		
2.C Block	5.Slab	8.				3.Defmoint 6.STYLE 9.None		
3.Br/Stone	6.Piers	9.				Econ. % Good		
Basement						Economic Code		
1.1/4 Bmt	4.Full Bmt	7.				0.None 3.Services 9.None		
2.1/2 Bmt	5.None	8.				1.Location 4.Traffic 8.		
3.3/4 Bmt	6.	9.None				2.Encroach 8.Other 9.		
Bsmt Gar # Cars						Entrance Code 0		
Wet Basement						1.Interior 4.Vacant 7.		
1.Dry	4.	7.				2.Refusal 5.Estimate 8.		
2.Damp	5.	8.	3.Informed 6. 9.					
3.Wet	6.	9.	Information Code 0					
Date Inspected			1.Owner 4.Agent 7.			2.Relative 5.Estimate 8.		
			2.Relative 5.Estimate 8.			3.Tenant 6.Other 9.		
Additions, Outbuildings & Improvements								1.ONE STORY FRAM
Type	Year	Units	Grade	Cond	Phys.	Funct.	Sound Value	2.TWO STORY FRAM
					%	%		3.THREE STORY FR
					%	%		4.1 & 1/2 STORY
					%	%		5.1 & 3/4 STORY
					%	%		6.2 & 1/2 STORY
					%	%		21.Open Frame Por
					%	%		22.Encl Frame Por
					%	%		23.Frame Garage
					%	%		24.Frame Shed
					%	%		25.Frame Bay Wind
					%	%		26.1SFr Overhang
					%	%		27.Unfin Basement
					%	%		28.Unfinished Att
					%	%		29.Finished Attic

Map Lot U19-009

Account 1817

Location 46 SHADY LANE

Card 1 Of 1 10/05/2023

HARPER, JOHN A
WISCASSET ME 04578

B2090P28

Inspection Witnessed By:

X

Date

No./Date	Description	Date Insp.

Notes:

WISCASSET

Property Data

Neighborhood 109 SOUTHEAST		
Tree Growth Year 0		
FARM LAND YEAR 0		
OPEN SPACE YEAR 0		
Zone/Land Use 21 RURAL		
Secondary Zone		
Topography 1 Level		
1.Level	4.Below St	7.Steep
2.Rolling	5.Low	8.Rough
3.Above St	6.Swampy	9.
Utilities 1 All Public		
1.Public	4.Dr Well	7.Cesspool
2.Water	5.DUG/LAKE	8.
3.Sewer	6.Septic	9.None
Street 1 Paved		
1.Paved	4.Proposed	7.
2.Semi Imp	5.Private	8.
3.Gravel	6.Pub Eas	9.NoStreet
TREE GROWTH PLAN 0		
CONSERV EASE 0		
Sale Data		
Sale Date		
Price		
Sale Type		
1.Land	4.Mobile	7.
2.L & B	5.Other	8.
3.Building	6.	9.
Financing		
1.Convent	4.Seller	7.
2.FHA/VA	5.Private	8.
3.Assumed	6.Cash	9.Unknown
Validity		
1.Valid	4.Split	7.Renovate
2.Related	5.Partial	8.Other
3.Distress	6.Exempt	9.Foreclose
Verified		
1.Buyer	4.Agent	7.Family
2.Seller	5.Pub Rec	8.Other
3.Lender	6.MLS	9.

Assessment Record

Year	Land	Buildings	Exempt	Total
2010	35,500	187,000	10,000	212,500
2011	35,500	187,000	10,000	212,500
2012	35,500	187,000	10,000	212,500
2013	35,500	187,000	10,000	212,500
2014	35,500	187,000	10,000	212,500
2015	35,500	187,000	10,000	212,500
2016	35,500	187,000	15,000	207,500
2017	35,500	187,000	20,000	202,500
2018	35,500	187,000	20,000	202,500
2019	35,500	187,000	20,000	202,500
2020	35,500	187,000	25,000	197,500
2021	35,500	187,000	25,000	197,500
2022	35,500	187,000	24,000	198,500
2023	44,400	233,700	25,000	253,100

Land Data

Front Foot	Type	Effective		Influence		Influence Codes
		Frontage	Depth	Factor	Code	
11.Regular Lot				%		1.Open Space
12.Delta Triangle				%		2.Neighborhood A
13.Nabla Triangle				%		3.Topography
14.Rear Land				%		4.Size/Shape
15.Front Foot				%		5.Access
				%		6.Restriction
				%		7.Corner/Locatio
				%		8.View/Environ
				%		9.Fract Share
				%		Acres
				%		30.Rear 20+
				%		31.Waterfront Rea
				%		32.Open Space
				%		33.RestrictEsm
				%		34.PASTURE 1
				%		35.HORTICULTURAL-
				%		36.Pasture 3
				%		37.Softwood
				%		38.Mixed Wood
				%		39.Hardwood
				%		40.Wasteland
				%		41.CAMP SITE
				%		42.Mobile Home Si
				%		43.Condo Site
				%		44.Site Improve
				%		45.CAMP SITE
				%		46.PAVING/00
		Acres/Sites				
20		1.00	100	%	0	
21		0.77	100	%	0	
		Acres				
24.Base Waterfron				%		
25.Shallow WF Siz				%		
26.Base Water Inf				%		
27.Influence W Si				%		
28.Rear Land 1-10				%		
29.Rear Land 11-2				%		
		Total Acreage		0.77		

WISCASSET

Map Lot U19-009

Account 1817

Location 46 SHADY LANE

Card 1

Of 1

10/05/2023

Building Style 5 Colonial	SF Bsmt Living 0	Layout 1 Typical
1.Conv. 5.Colonial 9.Other	Fin Bsmt Grade 0 0	1.Typical 4. 7.
2.Ranch 6.Split 10.Double	HEARTH 0	2.Inadeq 5. 8.
3.R Ranch 7.Mod/Cont 11.Multi	Heat Type 100% 7 Electric	3. 6. 9.
4.Cape 8.Log 12.Cot.	1.HWBB 5.FWA 9.No Heat	Attic 9 None
Dwelling Units 1	2.HWCI 6.GravWA 10.	1.1/4 Fin 4.Full Fin 7.
Other Units 0	3.H Pump 7.Electric 11.	2.1/2 Fin 5.F/Stair 8.
Stories 5 One & 3/4 Story	4.Steam 8.F/Wall 12.	3.3/4 Fin 6. 9.None
1.1 4.1.5 7.	Cool Type 0% 9 None	Insulation 1 Full
2.2 5.1.75 8.	1.Refrig 4.W&C Air 7.	1.Full 4.Minimal 7.
3.3 6.2.5 9.	2.Evapor 5. 8.	2.Heavy 5.Unknown 8.
Exterior Walls 2 WOOD SHINGLE	3.H Pump 6. 9.None	3.Capped 6. 9.None
1.CLAP 5.T-111 9.OTHER	Kitchen Style 2 TYPICAL	Unfinished % 0%
2.WD SH 6.BR/STONE 10.	1.GOOD 4.Obsolete 7.	Grade & Factor 4 Good 100%
3.COMP 7.NOV 11.	2.TYPICAL 5. 8.	1.E Grade 4.B Grade 7.AA+ Grad
4.ASB/ASP 8.AL/VIN 12.	3.OLD TYPE 6. 9.None	2.D Grade 5.A Grade 8.AA++Grad
Roof Surface 1 Asphalt Shingles	Bath(s) Style 2 TYPICAL	3.C Grade 6.AA Grade 9.Same
1.Asphalt 4.Composit 7.	1.GOOD 4.Obsolete 7.	SQFT (Footprint) 768
2.Slate 5.Wood 8.	2.TYPICAL 5. 8.	Condition 5 Above Average
3.Metal 6.Other 9.	3.Old Type 6. 9.None	1.Poor 4.Avg 7.V G
SF Masonry Trim 0	# Rooms 6	2.Fair 5.Avg+ 8.Exc
OPEN-3-CUSTOM 0	# Bedrooms 3	3.Avg- 6.Good 9.Same
OPEN-4-CUSTOM 0	# Full Baths 1	Phys. % Good 0%
Year Built 1982	# Half Baths 1	Funct. % Good 100%
Year Remodeled 0	# Addn Fixtures 0	Functional Code 9 None
Foundation 1 Concrete	# Fireplaces 1	1.Incomp 4.SMALL 7.LAYOUT
1.Concrete 4.Wood 7.		2.O-Built 5.CDU 8.OTHER
2.C Block 5.Slab 8.		3.Defmaint 6.STYLE 9.None
3.Br/Stone 6.Piers 9.		Econ. % Good 100%
Basement 4 Full Basement		Economic Code None
1.1/4 Bmt 4.Full Bmt 7.		0.None 3.Services 9.None
2.1/2 Bmt 5.None 8.		1.Location 4.Traffic 8.
3.3/4 Bmt 6. 9.None		2.Encroach 8.Other 9.
Bsmt Gar # Cars 0		Entrance Code 5 Estimated
Wet Basement 1 Dry Basement		1.Interior 4.Vacant 7.
1.Dry 4. 7.		2.Refusal 5.Estimate 8.
2.Damp 5. 8.		3.Informed 6. 9.
3.Wet 6. 9.		Information Code 5 Estimate
		1.Owner 4.Agent 7.
		2.Relative 5.Estimate 8.
		3.Tenant 6.Other 9.

Date Inspected 12/08/2006

Additions, Outbuildings & Improvements

Type	Year	Units	Grade	Cond	Phys.	Funct.	Sound Value	
1 ONE STORY	0	168	0 0	0	0 %	0 %		1.ONE STORY FRAM
21 Open Frame	0	86	0 0	0	0 %	0 %		2.TWO STORY FRAM
92 3/4S AD/GAR.....	0	672	0 0	0	0 %	0 %		3.THREE STORY FR
23 Frame Garage	2001	720	0 0	0	0 %	0 %		4.1 & 1/2 STORY
					%	%		5.1 & 3/4 STORY
					%	%		6.2 & 1/2 STORY
					%	%		21.Open Frame Por
					%	%		22.Encl Frame Por
					%	%		23.Frame Garage
					%	%		24.Frame Shed
					%	%		25.Frame Bay Wind
					%	%		26.1SFr Overhang
					%	%		27.Unfin Basement
					%	%		28.Unfinished Att
					%	%		29.Finished Attic

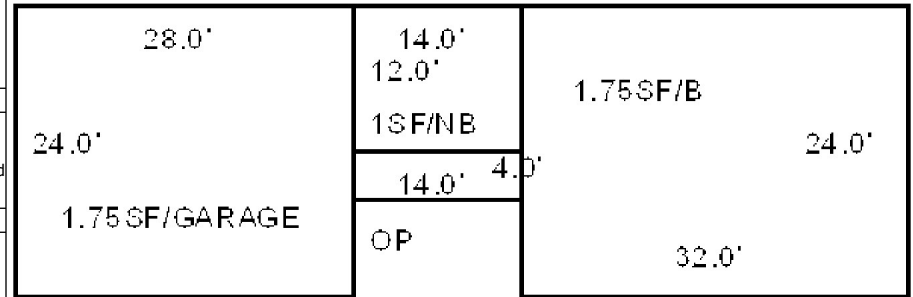

WISCASSET

Map Lot U19-010



Account 1818

Location 68 SHADY LANE

Card 1

Of 1

10/05/2023

Building Style 5 Colonial	SF Bsmt Living 0	Layout 1 Typical
1.Conv. 5.Colonial 9.Other	Fin Bsmt Grade 0 0	1.Typical 4. 7.
2.Ranch 6.Split 10.Double	HEARTH 0	2.Inadeq 5. 8.
3.R Ranch 7.Mod/Cont 11.Multi	Heat Type 100% 7 Electric	3. 6. 9.
4.Cape 8.Log 12.Cot.	1.HWBB 5.FWA 9.No Heat	Attic 9 None
Dwelling Units 1	2.HWCI 6.GravWA 10.	1.1/4 Fin 4.Full Fin 7.
Other Units 0	3.H Pump 7.Electric 11.	2.1/2 Fin 5.F/Stair 8.
Stories 2 Two Story	4.Steam 8.F/Wall 12.	3.3/4 Fin 6. 9.None
1.1 4.1.5 7.	Cool Type 0% 9 None	Insulation 1 Full
2.2 5.1.75 8.	1.Refrig 4.W&C Air 7.	1.Full 4.Minimal 7.
3.3 6.2.5 9.	2.Evapor 5. 8.	2.Heavy 5.Unknown 8.
Exterior Walls 8 ALUM/VINYL	3.H Pump 6. 9.None	3.Capped 6. 9.None
1.CLAP 5.T-111 9.OTHER	Kitchen Style 2 TYPICAL	Unfinished % 0%
2.WD SH 6.BR/STONE 10.	1.GOOD 4.Obsolete 7.	Grade & Factor 3 Average 100%
3.COMP 7.NOV 11.	2.TYPICAL 5. 8.	1.E Grade 4.B Grade 7.AA+ Grad
4.ASB/ASP 8.AL/VIN 12.	3.OLD TYPE 6. 9.None	2.D Grade 5.A Grade 8.AA++Grad
Roof Surface 1 Asphalt Shingles	Bath(s) Style 2 TYPICAL	3.C Grade 6.AA Grade 9.Same
1.Asphalt 4.Composit 7.	1.GOOD 4.Obsolete 7.	SQFT (Footprint) 1040
2.Slate 5.Wood 8.	2.TYPICAL 5. 8.	Condition 4 Average
3.Metal 6.Other 9.	3.Old Type 6. 9.None	1.Poor 4.Avg 7.V G
SF Masonry Trim 0	# Rooms 9	2.Fair 5.Avg+ 8.Exc
OPEN-3-CUSTOM 0	# Bedrooms 4	3.Avg- 6.Good 9.Same
OPEN-4-CUSTOM 0	# Full Baths 2	Phys. % Good 0%
Year Built 1979	# Half Baths 0	Funct. % Good 100%
Year Remodeled 0	# Addn Fixtures 0	Functional Code 9 None
Foundation 1 Concrete	# Fireplaces 0	1.Incomp 4.SMALL 7.LAYOUT
1.Concrete 4.Wood 7.		2.O-Built 5.CDU 8.OTHER
2.C Block 5.Slab 8.		3.Defmaint 6.STYLE 9.None
3.Br/Stone 6.Piers 9.		Econ. % Good 100%
Basement 4 Full Basement		Economic Code None
1.1/4 Bmt 4.Full Bmt 7.		0.None 3.Services 9.None
2.1/2 Bmt 5.None 8.		1.Location 4.Traffic 8.
3.3/4 Bmt 6. 9.None		2.Encroach 8.Other 9.
Bsmt Gar # Cars 0		Entrance Code 3 Information Only
Wet Basement 1 Dry Basement		1.Interior 4.Vacant 7.
1.Dry 4. 7.		2.Refusal 5.Estimate 8.
2.Damp 5. 8.		3.Informed 6. 9.
3.Wet 6. 9.		Information Code 3 Tenant
		1.Owner 4.Agent 7.
		2.Relative 5.Estimate 8.
		3.Tenant 6.Other 9.

GARAGE 24X30W 24X20 ADDITION

IGPOOL 16X32

POOL SHED 8X12

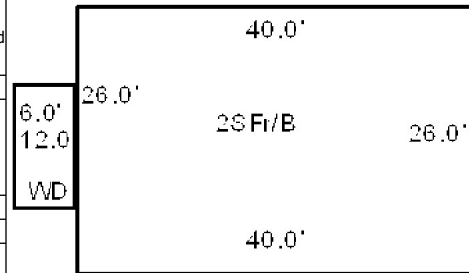

Date Inspected 12/08/2006

Additions, Outbuildings & Improvements

Type	Year	Units	Grade	Cond	Phys.	Funct.	Sound Value	
68 Wood Deck	1988	72	3 100	3	0 %	100 %		1.ONE STORY FRAM
23 Frame Garage	1979	720	3 100	4	0 %	100 %		2.TWO STORY FRAM
63 Swimming Pool	1988	512	3 100	4	99 %	100 %		3.THREE STORY FR
24 Frame Shed	1988	96	3 100	4	0 %	100 %		4.1 & 1/2 STORY
23 Frame Garage	1998	480	3 100	4	0 %	100 %		5.1 & 3/4 STORY
68 Wood Deck	2000	128	3 100	4	0 %	100 %		6.2 & 1/2 STORY
66 Res. Greenhouse	2014				%	%	1,000	21.Open Frame Por
					%	%		22.Encl Frame Por
					%	%		23.Frame Garage
					%	%		24.Frame Shed
					%	%		25.Frame Bay Wind
					%	%		26.1SFr Overhang
					%	%		27.Unfin Basement
					%	%		28.Unfinished Att
					%	%		29.Finished Attic

BUCCINA, ROBERT F BUCCINA, STACIE M 68 SHADY LANE WISCASSET ME 04578			Property Data			Assessment Record							
			Neighborhood 109 SOUTHEAST			Year	Land	Buildings	Exempt	Total			
						2020	0	4,500	4,500	0			
						2021	0	4,300	4,300	0			
						2022	0	4,000	4,000	0			
			Zone/Land Use 21 RURAL			2023	0	4,000	4,000	0			
			Secondary Zone										
						Topography 2 Rolling							
			1.Level 4.Below St 7.Steep 2.Rolling 5.Low 8.Rough 3.Above St 6.Swampy 9.										
			Utilities 1.Public 4.Dr Well 7.Cesspool 2.Water 5.DUG/LAKE 8. 3.Sewer 6.Septic 9.None										
			Street 1 Paved			Land Data							
			1.Paved 4.Proposed 7. 2.Semi Imp 5.Private 8. 3.Gravel 6.Pub Eas 9.NoStreet										
			TREE GROWTH PLAN 0										
			CONSERV EASE 0										
			Sale Data			Front Foot 11.Regular Lot 12.Delta Triangle 13.Nabla Triangle 14.Rear Land 15.Front Foot			Type		Effective		Influence
Sale Date			Frontage		Depth				Factor		Code		
Price									%				
Sale Type									%				
Inspection Witnessed By: X No./Date													

WISCASSET

Map Lot U19-010-ON

Account 2701

Location 68 SHADY LANE

Card 1 Of 1 10/05/2023

Building Style			SF Bsmt Living			Layout		
1.Conv.	5.Colonial	9.Other	Fin Bsmt Grade			1.Typical 4. 7.		
2.Ranch	6.Split	10.Double	HEARTH			2.Inadeq 5. 8.		
3.R Ranch	7.Mod/Cont	11.Multi	Heat Type 100%			3. 6. 9.		
4.Cape	8.Log	12.Cot.	1.HWBB 5.FWA 9.No Heat			Attic		
Dwelling Units			2.HWCI 6.GravWA 10.			1.1/4 Fin 4.Full Fin 7.		
Other Units			3.H Pump 7.Electric 11.			2.1/2 Fin 5.F/Stair 8.		
Stories			4.Steam 8.F/Wall 12.			3.3/4 Fin 6. 9.None		
1.1	4.1.5	7.	Cool Type 0%			Insulation		
2.2	5.1.75	8.	1.Refrig 4.W&C Air 7.			1.Full 4.Minimal 7.		
3.3	6.2.5	9.	2.Evapor 5. 8.			2.Heavy 5.Unknown 8.		
Exterior Walls			3.H Pump 6. 9.None			3.Capped 6. 9.None		
1.CLAP	5.T-111	9.OTHER	Kitchen Style			Unfinished %		
2.WD SH	6.BR/STONE	10.	1.GOOD 4.Obsolete 7.			Grade & Factor		
3.COMP	7.NOV	11.	2.TYPICAL 5. 8.			1.E Grade 4.B Grade 7.AA+ Grad		
4.ASB/ASP	8.AL/VIN	12.	3.OLD TYPE 6. 9.None			2.D Grade 5.A Grade 8.AA++Grad		
Roof Surface			Bath(s) Style			3.C Grade 6.AA Grade 9.Same		
1.Asphalt	4.Composit	7.	1.GOOD 4.Obsolete 7.			SQFT (Footprint)		
2.Slate	5.Wood	8.	2.TYPICAL 5. 8.			Condition		
3.Metal	6.Other	9.	3.Old Type 6. 9.None			1.Poor 4.Avg 7.V G		
SF Masonry Trim			# Rooms			2.Fair 5.Avg+ 8.Exc		
OPEN-3-CUSTOM			# Bedrooms			3.Avg- 6.Good 9.Same		
OPEN-4-CUSTOM			# Full Baths			Phys. % Good		
Year Built			# Half Baths			Funct. % Good		
Year Remodeled			# Addn Fixtures			Functional Code		
Foundation			# Fireplaces			1.Incomp 4.SMALL 7.LAYOUT		
1.Concrete	4.Wood	7.				2.O-Built 5.CDU 8.OTHER		
2.C Block	5.Slab	8.				3.Defmoint 6.STYLE 9.None		
3.Br/Stone	6.Piers	9.				Econ. % Good		
Basement						Economic Code		
1.1/4 Bmt	4.Full Bmt	7.				0.None 3.Services 9.None		
2.1/2 Bmt	5.None	8.				1.Location 4.Traffic 8.		
3.3/4 Bmt	6.	9.None				2.Encroach 8.Other 9.		
Bsmt Gar # Cars						Entrance Code 0		
Wet Basement						1.Interior 4.Vacant 7.		
1.Dry	4.	7.				2.Refusal 5.Estimate 8.		
2.Damp	5.	8.				3.Informed 6. 9.		
3.Wet	6.	9.				Information Code 0		
						1.Owner 4.Agent 7.		
						2.Relative 5.Estimate 8.		
						3.Tenant 6.Other 9.		
Date Inspected								
Additions, Outbuildings & Improvements								1.ONE STORY FRAM
Type	Year	Units	Grade	Cond	Phys.	Funct.	Sound Value	2.TWO STORY FRAM
124 SOLAR PANELS	2019				%	%	4,000	3.THREE STORY FR
					%	%		4.1 & 1/2 STORY
					%	%		5.1 & 3/4 STORY
					%	%		6.2 & 1/2 STORY
					%	%		21.Open Frame Por
					%	%		22.Encl Frame Por
					%	%		23.Frame Garage
					%	%		24.Frame Shed
					%	%		25.Frame Bay Wind
					%	%		26.1SFr Overhang
					%	%		27.Unfin Basement
					%	%		28.Unfinished Att
					%	%		29.Finished Attic

Map Lot U19-011

Account 1819

Location 30 SHADY LANE

Card 1 Of 1 10/05/2023

GOODWIN, EVAN TUCKER
30 SHADY LANE
WISCASSET ME 04578

B5687P58

Previous Owner
MCKARNS, REBECCA A J/T
MCKARNS, LYLE J

WISCASSET ME 04578
Sale Date: 3/31/2021

Previous Owner
JOSLYN, MELANIE S.
C/O LYLE & REBECCA MCKARNS
30 SHADY LANE
WISCASSET ME 04578
Sale Date: 6/06/2011

Previous Owner
DAY, PERLEY E.
C/O MELANIE S. JOSLYN
30 SHADY LANE
WISCASSET ME 04578
Sale Date: 7/22/2005

Inspection Witnessed By:

X

Date

No./Date	Description	Date Insp.

Notes:

7/19/22 NAH VENT PIPE ON GAR ROOF (PLUMB PERMIT),
EST BATHROOM, ADD SHED NPA
2006-PREVIOUS OWNER: PERLEY E. DAY BK2381 PG65,
BK2282 PG2, sold for \$150,000 in 2005.

WISCASSET

Property Data

Neighborhood	109 SOUTHEAST		
Tree Growth Year	0		
FARM LAND YEAR	0		
OPEN SPACE YEAR	0		
Zone/Land Use	21 RURAL		
Secondary Zone			
Topography	1 Level	3 Above Street	
1.Level	4.Below St	7.Steep	
2.Rolling	5.Low	8.Rough	
3.Above St	6.Swampy	9.	
Utilities	4 Drilled Well	6 Septic System	
1.Public	4.Dr Well	7.Cesspool	
2.Water	5.DUG/LAKE	8.	
3.Sewer	6.Septic	9.None	
Street	1 Paved		
1.Paved	4.Proposed	7.	
2.Semi Imp	5.Private	8.	
3.Gravel	6.Pub Eas	9.NoStreet	
TREE GROWTH PLAN	0		
CONSERV EASE	0		
Sale Data			
Sale Date	3/31/2021		
Price	262,500		
Sale Type	2 Land & Buildings		
1.Land	4.Mobile	7.	
2.L & B	5.Other	8.	
3.Building	6.	9.	
Financing	9 Unknown		
1.Convent	4.Seller	7.	
2.FHA/VA	5.Private	8.	
3.Assumed	6.Cash	9.Unknown	
Validity	1 Arms Length Sale		
1.Valid	4.Split	7.Renovate	
2.Related	5.Partial	8.Other	
3.Distress	6.Exempt	9.Foreclose	
Verified	5 Public Record		
1.Buyer	4.Agent	7.Family	
2.Seller	5.Pub Rec	8.Other	
3.Lender	6.MLS	9.	

Assessment Record

Year	Land	Buildings	Exempt	Total
2010	35,000	121,400	0	156,400
2011	35,000	121,400	0	156,400
2012	35,000	121,400	0	156,400
2013	35,000	121,400	0	156,400
2014	35,000	121,400	0	156,400
2015	35,000	121,400	0	156,400
2016	35,000	121,400	0	156,400
2017	35,000	121,400	0	156,400
2018	35,000	121,400	0	156,400
2019	35,000	121,400	20,000	136,400
2020	35,000	121,400	25,000	131,400
2021	35,000	121,400	0	156,400
2022	35,000	124,600	0	159,600
2023	43,700	155,600	0	199,300

Land Data

Front Foot	Type	Effective		Influence		Influence Codes
		Frontage	Depth	Factor	Code	
11.Regular Lot				%		1.Open Space
12.Delta Triangle				%		2.Neighborhood A
13.Nabla Triangle				%		3.Topography
14.Rear Land				%		4.Size/Shape
15.Front Foot				%		5.Access
				%		6.Restriction
				%		7.Corner/Locatio
				%		8.View/Environ
				%		9.Fract Share
				%		Acres
				%		30.Rear 20+
				%		31.Waterfront Rea
				%		32.Open Space
				%		33.RestrictEsm
				%		34.PASTURE 1
				%		35.HORTICULTURAL-
				%		36.Pasture 3
				%		37.Softwood
				%		38.Mixed Wood
				%		39.Hardwood
				%		40.Wasteland
				%		41.CAMP SITE
				%		42.Mobile Home Si
				%		43.Condo Site
				%		44.Site Improve
				%		45.CAMP SITE
				%		46.PAVING/00
Total Acreage		0.60				

Front Foot

11.Regular Lot
12.Delta Triangle
13.Nabla Triangle
14.Rear Land
15.Front Foot

Square Foot

16.Regular Lot
17.Secondary Site
18.Secondary Site
19.Condominium
20.Base Homesite

Fract. Acre

21.HS Size Adj
22.Base Waterfron
23.Deep WF Size A

Acres

24.Base Waterfron
25.Shallow WF Siz
26.Base Water Inf
27.Influence W Si
28.Rear Land 1-10
29.Rear Land 11-2

Type

11.Regular Lot
12.Delta Triangle
13.Nabla Triangle
14.Rear Land
15.Front Foot

Square Feet

16.Regular Lot
17.Secondary Site
18.Secondary Site
19.Condominium
20.Base Homesite

Fract. Acre

21.HS Size Adj
22.Base Waterfron
23.Deep WF Size A

Acres

24.Base Waterfron
25.Shallow WF Siz
26.Base Water Inf
27.Influence W Si
28.Rear Land 1-10
29.Rear Land 11-2

Effective

11.Regular Lot
12.Delta Triangle
13.Nabla Triangle
14.Rear Land
15.Front Foot

Square Feet

16.Regular Lot
17.Secondary Site
18.Secondary Site
19.Condominium
20.Base Homesite

Fract. Acre

21.HS Size Adj
22.Base Waterfron
23.Deep WF Size A

Acres

24.Base Waterfron
25.Shallow WF Siz
26.Base Water Inf
27.Influence W Si
28.Rear Land 1-10
29.Rear Land 11-2

Influence

11.Regular Lot
12.Delta Triangle
13.Nabla Triangle
14.Rear Land
15.Front Foot

Square Feet

16.Regular Lot
17.Secondary Site
18.Secondary Site
19.Condominium
20.Base Homesite

Fract. Acre

21.HS Size Adj
22.Base Waterfron
23.Deep WF Size A

Acres

24.Base Waterfron
25.Shallow WF Siz
26.Base Water Inf
27.Influence W Si
28.Rear Land 1-10
29.Rear Land 11-2

Influence Codes

1.Open Space
2.Neighborhood A
3.Topography
4.Size/Shape
5.Access
6.Restriction
7.Corner/Locatio
8.View/Environ
9.Fract Share
Acres
30.Rear 20+
31.Waterfront Rea
32.Open Space
33.RestrictEsm
34.PASTURE 1
35.HORTICULTURAL-
36.Pasture 3
37.Softwood
38.Mixed Wood
39.Hardwood
40.Wasteland
41.CAMP SITE
42.Mobile Home Si
43.Condo Site
44.Site Improve
45.CAMP SITE
46.PAVING/00

WISCASSET

Map Lot U19-011

Account 1819

Location 30 SHADY LANE

Card 1

Of 1

10/05/2023

Building Style 3 Raised Ranch	SF Bsmt Living 896	Layout 1 Typical
1.Conv. 5.Colonial 9.Other	Fin Bsmt Grade 9 100	1.Typical 4. 7.
2.Ranch 6.Split 10.Double	HEARTH 2	2.Inadeq 5. 8.
3.R Ranch 7.Mod/Cont 11.Multi	Heat Type 100% 1 Hot Water BB	3. 6. 9.
4.Cape 8.Log 12.Cot.	1.HWBB 5.FWA 9.No Heat	Attic 9 None
Dwelling Units 1	2.HWCI 6.GravWA 10.	1.1/4 Fin 4.Full Fin 7.
Other Units 0	3.H Pump 7.Electric 11.	2.1/2 Fin 5.F/Stair 8.
Stories 1 One Story	4.Steam 8.F/Wall 12.	3.3/4 Fin 6. 9.None
1.1 4.1.5 7.	Cool Type 0% 9 None	Insulation 1 Full
2.2 5.1.75 8.	1.Refrig 4.W&C Air 7.	1.Full 4.Minimal 7.
3.3 6.2.5 9.	2.Evapor 5. 8.	2.Heavy 5.Unknown 8.
Exterior Walls 3 COMPOSITION	3.H Pump 6. 9.None	3.Capped 6. 9.None
1.CLAP 5.T-111 9.OTHER	Kitchen Style 2 TYPICAL	Unfinished % 0%
2.WD SH 6.BR/STONE 10.	1.GOOD 4.Obsolete 7.	Grade & Factor 3 Average 100%
3.COMP 7.NOV 11.	2.TYPICAL 5. 8.	1.E Grade 4.B Grade 7.AA+ Grad
4.ASB/ASP 8.AL/VIN 12.	3.OLD TYPE 6. 9.None	2.D Grade 5.A Grade 8.AA++Grad
Roof Surface 1 Asphalt Shingles	Bath(s) Style 2 TYPICAL	3.C Grade 6.AA Grade 9.Same
1.Asphalt 4.Composit 7.	1.GOOD 4.Obsolete 7.	SQFT (Footprint) 1040
2.Slate 5.Wood 8.	2.TYPICAL 5. 8.	Condition 4 Average
3.Metal 6.Other 9.	3.Old Type 6. 9.None	1.Poor 4.Avg 7.V G
SF Masonry Trim 0	# Rooms 6	2.Fair 5.Avg+ 8.Exc
OPEN-3-CUSTOM 0	# Bedrooms 3	3.Avg- 6.Good 9.Same
OPEN-4-CUSTOM 0	# Full Baths 3	Phys. % Good 0%
Year Built 1978	# Half Baths 0	Funct. % Good 100%
Year Remodeled 0	# Addn Fixtures 0	Functional Code 9 None
Foundation 1 Concrete	# Fireplaces 0	1.Incomp 4.SMALL 7.LAYOUT
1.Concrete 4.Wood 7.		2.O-Built 5.CDU 8.OTHER
2.C Block 5.Slab 8.		3.Defmaint 6.STYLE 9.None
3.Br/Stone 6.Piers 9.		Econ. % Good 100%
Basement 4 Full Basement		Economic Code None
1.1/4 Bmt 4.Full Bmt 7.		0.None 3.Services 9.None
2.1/2 Bmt 5.None 8.		1.Location 4.Traffic 8.
3.3/4 Bmt 6. 9.None		2.Encroach 8.Other 9.
Bsmt Gar # Cars 0		Entrance Code 5 Estimated
Wet Basement 1 Dry Basement		1.Interior 4.Vacant 7.
1.Dry 4. 7.		2.Refusal 5.Estimate 8.
2.Damp 5. 8.		3.Informed 6. 9.
3.Wet 6. 9.		Information Code 5 Estimate
		1.Owner 4.Agent 7.
		2.Relative 5.Estimate 8.
		3.Tenant 6.Other 9.

Date Inspected 12/08/2006

Additions, Outbuildings & Improvements

Type	Year	Units	Grade	Cond	Phys.	Funct.	Sound Value
26 1SFr Overhang	0	33	0 0	0	0 %	0 %	
23 Frame Garage	0	308	0 0	0	0 %	0 %	
68 Wood Deck	1978	80	0 0	0	0 %	0 %	
68 Wood Deck	2002	192	3 100	4	0 %	100 %	
24 Frame Shed	0				%	%	400
					%	%	
					%	%	
					%	%	
					%	%	
					%	%	

10.0'
10.0'
SHED

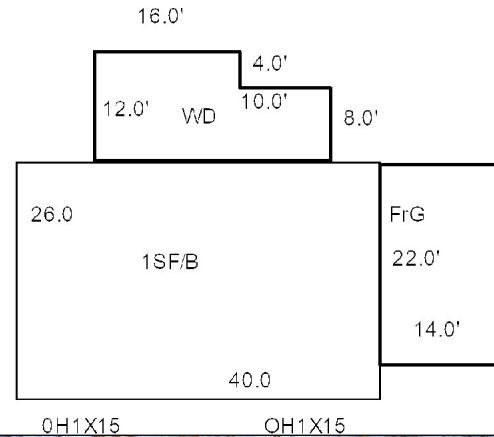

Map Lot U19-012

Account 1820

Location 806 BATH ROAD

Card 1 Of 1 10/05/2023

DELGAUDIO, ANTHONY
TOPSHAM ME 04086

B4804P157

Previous Owner
CHAPMAN, KENNETH W.
C/O ANTHONY DELGAUDIO
59 ELM STREET
TOPSHAM ME 04086
Sale Date: 7/30/2140

Previous Owner
CHAPMAN, PRISCILLA JANE (J/T)
CHAPMAN, KENNETH W.

WISCASSET ME 04578
Sale Date: 2/01/2008

Inspection Witnessed By:

X

Date

No./Date	Description	Date Insp.

Notes:

2002 CREATED J/T WITH SON PREVIOUS BK2339 PG0330
2010-Release deed recorded.
7/31/14-Notice received from the attorney that this property
sold to Anthony DelGaudio in Topsham. Bill for 2014 will be
mailed to Mr. DelGaudio.

WISCASSET

Property Data

Neighborhood	200 U.S. RTE 1		
Tree Growth Year	0		
FARM LAND YEAR	0		
OPEN SPACE YEAR	0		
Zone/Land Use	21 RURAL		
Secondary Zone			
Topography	1 Level		
1.Level	4.Below St	7.Steep	
2.Rolling	5.Low	8.Rough	
3.Above St	6.Swampy	9.	
Utilities	9 NoWater/NoSewer		
1.Public	4.Dr Well	7.Cesspool	
2.Water	5.DUG/LAKE	8.	
3.Sewer	6.Septic	9.None	
Street	1 Paved		
1.Paved	4.Proposed	7.	
2.Semi Imp	5.Private	8.	
3.Gravel	6.Pub Eas	9.NoStreet	
TREE GROWTH PLAN	0		
CONSERV EASE	0		
Sale Data			
Sale Date	7/30/2014		
Price	70,000		
Sale Type	1 Land Only		
1.Land	4.Mobile	7.	
2.L & B	5.Other	8.	
3.Building	6.	9.	
Financing	9 Unknown		
1.Convent	4.Seller	7.	
2.FHA/VA	5.Private	8.	
3.Assumed	6.Cash	9.Unknown	
Validity	1 Arms Length Sale		
1.Valid	4.Split	7.Renovate	
2.Related	5.Partial	8.Other	
3.Distress	6.Exempt	9.Foreclose	
Verified	5 Public Record		
1.Buyer	4.Agent	7.Family	
2.Seller	5.Pub Rec	8.Other	
3.Lender	6.MLS	9.	

Assessment Record

Year	Land	Buildings	Exempt	Total
2010	62,000	0	0	62,000
2011	62,000	0	0	62,000
2012	62,000	0	0	62,000
2013	62,000	0	0	62,000
2014	62,000	0	0	62,000
2015	62,000	0	0	62,000
2016	62,000	0	0	62,000
2017	62,000	0	0	62,000
2018	62,000	0	0	62,000
2019	62,000	0	0	62,000
2020	62,000	0	0	62,000
2021	62,000	0	0	62,000
2022	62,000	0	0	62,000
2023	77,500	0	0	77,500

Land Data

Front Foot	Type	Effective		Influence		Influence Codes
		Frontage	Depth	Factor	Code	
11.Regular Lot				%		1.Open Space
12.Delta Triangle				%		2.Neighborhood A
13.Nabla Triangle				%		3.Topography
14.Rear Land				%		4.Size/Shape
15.Front Foot				%		5.Access
				%		6.Restriction
				%		7.Corner/Locatio
				%		8.View/Environ
				%		9.Fract Share
				%		Acres
				%		30.Rear 20+
				%		31.Waterfront Rea
				%		32.Open Space
				%		33.RestrictEsm
				%		34.PASTURE 1
				%		35.HORTICULTURAL-
				%		36.Pasture 3
				%		37.Softwood
				%		38.Mixed Wood
				%		39.Hardwood
				%		40.Wasteland
				%		41.CAMP SITE
				%		42.Mobile Home Si
				%		43.Condo Site
				%		44.Site Improve
				%		45.CAMP SITE
				%		46.PAVING/00
Total Acreage		7.00				

WISCASSET

Map Lot U19-012

Account 1820

Location 806 BATH ROAD

Card 1 Of 1 10/05/2023

Building Style			SF Bsmt Living			Layout		
1.Conv.	5.Colonial	9.Other	Fin Bsmt Grade			1.Typical 4. 7.		
2.Ranch	6.Split	10.Double	HEARTH			2.Inadeq 5. 8.		
3.R Ranch	7.Mod/Cont	11.Multi	Heat Type 100%			3. 6. 9.		
4.Cape	8.Log	12.Cot.	1.HWBB 5.FWA 9.No Heat			Attic		
Dwelling Units			2.HWCI 6.GravWA 10.			1.1/4 Fin 4.Full Fin 7.		
Other Units			3.H Pump 7.Electric 11.			2.1/2 Fin 5.F/Stair 8.		
Stories			4.Steam 8.F/Wall 12.			3.3/4 Fin 6. 9.None		
1.1	4.1.5	7.	Cool Type 0%			Insulation		
2.2	5.1.75	8.	1.Refrig 4.W&C Air 7.			1.Full 4.Minimal 7.		
3.3	6.2.5	9.	2.Evapor 5. 8.			2.Heavy 5.Unknown 8.		
Exterior Walls			3.H Pump 6. 9.None			3.Capped 6. 9.None		
1.CLAP	5.T-111	9.OTHER	Kitchen Style			Unfinished %		
2.WD SH	6.BR/STONE	10.	1.GOOD 4.Obsolete 7.			Grade & Factor		
3.COMP	7.NOV	11.	2.TYPICAL 5. 8.			1.E Grade 4.B Grade 7.AA+ Grad		
4.ASB/ASP	8.AL/VIN	12.	3.OLD TYPE 6. 9.None			2.D Grade 5.A Grade 8.AA++Grad		
Roof Surface			Bath(s) Style			3.C Grade 6.AA Grade 9.Same		
1.Asphalt	4.Composit	7.	1.GOOD 4.Obsolete 7.			SQFT (Footprint)		
2.Slate	5.Wood	8.	2.TYPICAL 5. 8.			Condition		
3.Metal	6.Other	9.	3.Old Type 6. 9.None			1.Poor 4.Avg 7.V G		
SF Masonry Trim			# Rooms			2.Fair 5.Avg+ 8.Exc		
OPEN-3-CUSTOM			# Bedrooms			3.Avg- 6.Good 9.Same		
OPEN-4-CUSTOM			# Full Baths			Phys. % Good		
Year Built			# Half Baths			Funct. % Good		
Year Remodeled			# Addn Fixtures			Functional Code		
Foundation			# Fireplaces			1.Incomp 4.SMALL 7.LAYOUT		
1.Concrete	4.Wood	7.				2.O-Built 5.CDU 8.OTHER		
2.C Block	5.Slab	8.				3.Defmait 6.STYLE 9.None		
3.Br/Stone	6.Piers	9.				Econ. % Good		
Basement						Economic Code		
1.1/4 Bmt	4.Full Bmt	7.				0.None 3.Services 9.None		
2.1/2 Bmt	5.None	8.				1.Location 4.Traffic 8.		
3.3/4 Bmt	6. 9.None					2.Encroach 8.Other 9.		
Bsmt Gar # Cars						Entrance Code 4 Unoccupied		
Wet Basement						1.Interior 4.Vacant 7.		
1.Dry	4. 7.					2.Refusal 5.Estimate 8.		
2.Damp	5. 8.		3.Informed 6. 9.					
3.Wet	6. 9.		Information Code 5 Estimate					
Date Inspected			1.Owner 4.Agent 7.			2.Relative 5.Estimate 8.		
			3.Tenant 6.Other 9.					
Additions, Outbuildings & Improvements								1.ONE STORY FRAM
Type	Year	Units	Grade	Cond	Phys.	Funct.	Sound Value	2.TWO STORY FRAM
					%	%		3.THREE STORY FR
					%	%		4.1 & 1/2 STORY
					%	%		5.1 & 3/4 STORY
					%	%		6.2 & 1/2 STORY
					%	%		21.Open Frame Por
					%	%		22.Encl Frame Por
					%	%		23.Frame Garage
					%	%		24.Frame Shed
					%	%		25.Frame Bay Wind
					%	%		26.1SFr Overhang
					%	%		27.Unfin Basement
					%	%		28.Unfinished Att
					%	%		29.Finished Attic

Property Data			Assessment Record						
Neighborhood 109 SOUTHEAST			Year	Land	Buildings	Exempt	Total		
			2010	36,800	271,200	16,000	292,000		
Tree Growth Year 0			2011	36,800	271,200	16,000	292,000		
FARM LAND YEAR 0			2012	36,800	271,200	16,000	292,000		
OPEN SPACE YEAR 0			2013	36,800	271,200	16,000	292,000		
Zone/Land Use 21 RURAL			2014	36,800	271,200	16,000	292,000		
Secondary Zone			2015	36,800	271,200	16,000	292,000		
			2016	36,800	271,200	21,000	287,000		
Topography 3 Above Street			2017	36,800	271,200	26,000	282,000		
1.Level	4.Below St	7.Steep	2018	36,800	271,200	26,000	282,000		
2.Rolling	5.Low	8.Rough	2019	36,800	271,200	26,000	282,000		
3.Above St	6.Swampy	9.	2020	36,800	271,200	31,000	277,000		
Utilities	4 Drilled Well	6 Septic System	2021	36,800	271,200	31,000	277,000		
1.Public	4.Dr Well	7.Cesspool	2022	36,800	271,200	29,760	278,240		
2.Water	5.DUG/LAKE	8.	2023	46,000	339,000	31,000	354,000		
3.Sewer	6.Septic	9.None	Land Data						
Street	1 Paved								
1.Paved	4.Proposed	7.	Front Foot	Type	Effective		Influence		Influence Codes
2.Semi Imp	5.Private	8.			Frontage	Depth	Factor	Code	
3.Gravel	6.Pub Eas	9.NoStreet							
TREE GROWTH PLAN	0								
CONSERV EASE	0								
Sale Data									
Sale Date									
Price									
Sale Type									
1.Land	4.Mobile	7.	Square Foot		Square Feet				
2.L & B	5.Other	8.							
3.Building	6.	9.							
Financing									
1.Convent	4.Seller	7.							
2.FHA/VA	5.Private	8.							
3.Assumed	6.Cash	9.Unknown							
Validity			Fract. Acre		Acreage/Sites				
1.Valid	4.Split	7.Renovate			20	1.00	100	%	0
2.Related	5.Partial	8.Other			21	1.00	100	%	0
3.Distress	6.Exempt	9.Foreclose			28	0.24	100	%	0
Verified									
1.Buyer	4.Agent	7.Family							
2.Seller	5.Pub Rec	8.Other	Total Acreage 1.24						
3.Lender	6.MLS	9.							

Map Lot U19-013 Account 1821 Location 22 SHADY LANE Card 1 Of 1 10/05/2023

[illegible]

Additions, Outbuildings & Improvements								1.ONE STORY FRAM
Type	Year	Units	Grade	Cond	Phys.	Funct.	Sound Value	2.TWO STORY FRAM
79 2 STORY	0	660	3 100	4	0 %	80 %		3.THREE STORY FR
2 TWO STORY	0	140	0 0	0	0 %	0 %		4.1 & 1/2 STORY
26 1SFr Overhang	0	14	0 0	0	0 %	0 %		5.1 & 3/4 STORY
22 Encl Frame Porch	0	20	0 0	0	0 %	0 %		6.2 & 1/2 STORY
68 Wood Deck	0	196	0 0	0	0 %	0 %		21.Open Frame Por
68 Wood Deck	0	210	0 0	0	0 %	0 %		22.Encl Frame Por
26 1SFr Overhang	0	24	0 0	0	0 %	0 %		23.Frame Garage
26 1SFr Overhang	0	5	0 0	0	0 %	0 %		24.Frame Shed
					%	%		25.Frame Bay Wind
					%	%		26.1SFr Overhang
					%	%		27.Unfin Basement
					%	%		28.Unfinished Att
					%	%		29.Finished Attic

Map Lot U19-014

Account 1822

Location 16 SHADY LANE

Card 1 Of 1 10/05/2023

DALTON, ZACHARY A
DALTON, PETER R
16 SHADY LANE
WISCASSET ME 04578

B1723P205 B4664P31 B4939P205 B4946P261

Previous Owner
LEMAR, GREGORY L.
P.O. BOX 598

WISCASSET ME 04578
Sale Date: 10/27/2015

Previous Owner
CRONK, WILFORD S. (DEVISEES)
BAILEY J,CRONK W,CRONK D,BERGERON S, PINKHAM D
C/O DAVID L. CRONK
WISCASSET ME 04578
Sale Date: 10/02/2015

Inspection Witnessed By:

X

Date

No./Date	Description	Date Insp.

Notes:

2002-24 X 26 GARAGE ADDED

2013-Mr. Cronk passed away March 25, 2013. Removed
homestead and veterans exemption.

WISCASSET

Property Data

Neighborhood	109 SOUTHEAST		
Tree Growth Year	0		
FARM LAND YEAR	0		
OPEN SPACE YEAR	0		
Zone/Land Use	21 RURAL		
Secondary Zone			
Topography		3 Above Street	
1.Level	4.Below St	7.Steep	
2.Rolling	5.Low	8.Rough	
3.Above St	6.Swampy	9.	
Utilities	4 Drilled Well	6 Septic System	
1.Public	4.Dr Well	7.Cesspool	
2.Water	5.DUG/LAKE	8.	
3.Sewer	6.Septic	9.None	
Street	1 Paved		
1.Paved	4.Proposed	7.	
2.Semi Imp	5.Private	8.	
3.Gravel	6.Pub Eas	9.NoStreet	
TREE GROWTH PLAN	0		
CONSERV EASE	0		
Sale Data			
Sale Date	10/27/2015		
Price	115,000		
Sale Type	2 Land & Buildings		
1.Land	4.Mobile	7.	
2.L & B	5.Other	8.	
3.Building	6.	9.	
Financing	9 Unknown		
1.Convent	4.Seller	7.	
2.FHA/VA	5.Private	8.	
3.Assumed	6.Cash	9.Unknown	
Validity	1 Arms Length Sale		
1.Valid	4.Split	7.Renovate	
2.Related	5.Partial	8.Other	
3.Distress	6.Exempt	9.Foreclose	
Verified	5 Public Record		
1.Buyer	4.Agent	7.Family	
2.Seller	5.Pub Rec	8.Other	
3.Lender	6.MLS	9.	

Assessment Record

Year	Land	Buildings	Exempt	Total
2010	34,900	79,600	16,000	98,500
2011	34,900	79,600	16,000	98,500
2012	34,900	79,600	16,000	98,500
2013	34,900	79,600	0	114,500
2014	34,900	79,600	0	114,500
2015	34,900	79,600	0	114,500
2016	34,900	79,600	0	114,500
2017	34,900	79,600	0	114,500
2018	34,900	79,600	0	114,500
2019	34,900	79,600	0	114,500
2020	34,900	79,600	0	114,500
2021	34,900	79,600	0	114,500
2022	34,900	79,600	0	114,500
2023	43,700	99,500	25,000	118,200

Land Data

Front Foot	Type	Effective		Influence		Influence Codes
		Frontage	Depth	Factor	Code	
11.Regular Lot				%		1.Open Space
12.Delta Triangle				%		2.Neighborhood A
13.Nabla Triangle				%		3.Topography
14.Rear Land				%		4.Size/Shape
15.Front Foot				%		5.Access
				%		6.Restriction
				%		7.Corner/Locatio
				%		8.View/Environ
				%		9.Fract Share
				%		Acres
				%		30.Rear 20+
				%		31.Waterfront Rea
				%		32.Open Space
				%		33.RestrictEsm
				%		34.PASTURE 1
				%		35.HORTICULTURAL-
				%		36.Pasture 3
				%		37.Softwood
				%		38.Mixed Wood
				%		39.Hardwood
				%		40.Wasteland
				%		41.CAMP SITE
				%		42.Mobile Home Si
				%		43.Condo Site
				%		44.Site Improve
				%		45.CAMP SITE
				%		46.PAVING/00
Total Acreage		0.59				

WISCASSET

Map Lot U19-014

Account 1822

Location 16 SHADY LANE

Card 1

Of 1

10/05/2023

Building Style 10 Double Wide	SF Bsmt Living 0	Layout 1 Typical
1.Conv. 5.Colonial 9.Other	Fin Bsmt Grade 0 0	1.Typical 4. 7.
2.Ranch 6.Split 10.Double	HEARTH 0	2.Inadeq 5. 8.
3.R Ranch 7.Mod/Cont 11.Multi	Heat Type 100% 5 Forced Warm Air	3. 6. 9.
4.Cape 8.Log 12.Cot.	1.HWBB 5.FWA 9.No Heat	Attic 9 None
Dwelling Units 1	2.HWCI 6.GravWA 10.	1.1/4 Fin 4.Full Fin 7.
Other Units 0	3.H Pump 7.Electric 11.	2.1/2 Fin 5.F/Stair 8.
Stories 1 One Story	4.Steam 8.F/Wall 12.	3.3/4 Fin 6. 9.None
1.1 4.1.5 7.	Cool Type 0% 9 None	Insulation 1 Full
2.2 5.1.75 8.	1.Refrig 4.W&C Air 7.	1.Full 4.Minimal 7.
3.3 6.2.5 9.	2.Evapor 5. 8.	2.Heavy 5.Unknown 8.
Exterior Walls 8 ALUM/VINYL	3.H Pump 6. 9.None	3.Capped 6. 9.None
1.CLAP 5.T-111 9.OTHER	Kitchen Style 2 TYPICAL	Unfinished % 0%
2.WD SH 6.BR/STONE 10.	1.GOOD 4.Obsolete 7.	Grade & Factor 2 Fair 100%
3.COMP 7.NOV 11.	2.TYPICAL 5. 8.	1.E Grade 4.B Grade 7.AA+ Grad
4.ASB/ASP 8.AL/VIN 12.	3.OLD TYPE 6. 9.None	2.D Grade 5.A Grade 8.AA++Grad
Roof Surface 1 Asphalt Shingles	Bath(s) Style 2 TYPICAL	3.C Grade 6.AA Grade 9.Same
1.Asphalt 4.Composit 7.	1.GOOD 4.Obsolete 7.	SQFT (Footprint) 1152
2.Slate 5.Wood 8.	2.TYPICAL 5. 8.	Condition 4 Average
3.Metal 6.Other 9.	3.Old Type 6. 9.None	1.Poor 4.Avg 7.V G
SF Masonry Trim 0	# Rooms 5	2.Fair 5.Avg+ 8.Exc
OPEN-3-CUSTOM 0	# Bedrooms 3	3.Avg- 6.Good 9.Same
OPEN-4-CUSTOM 0	# Full Baths 2	Phys. % Good 0%
Year Built 1994	# Half Baths 0	Funct. % Good 100%
Year Remodeled 0	# Addn Fixtures 0	Functional Code 9 None
Foundation 1 Concrete	# Fireplaces 1	1.Incomp 4.SMALL 7.LAYOUT
1.Concrete 4.Wood 7.		2.O-Built 5.CDU 8.OTHER
2.C Block 5.Slab 8.		3.Defmaint 6.STYLE 9.None
3.Br/Stone 6.Piers 9.		Econ. % Good 100%
Basement 4 Full Basement		Economic Code None
1.1/4 Bmt 4.Full Bmt 7.		0.None 3.Services 9.None
2.1/2 Bmt 5.None 8.		1.Location 4.Traffic 8.
3.3/4 Bmt 6. 9.None		2.Encroach 8.Other 9.
Bsmt Gar # Cars 0		Entrance Code 1 Interior Inspect
Wet Basement 1 Dry Basement		1.Interior 4.Vacant 7.
1.Dry 4. 7.		2.Refusal 5.Estimate 8.
2.Damp 5. 8.		3.Informed 6. 9.
3.Wet 6. 9.		Information Code 1 Owner
		1.Owner 4.Agent 7.
		2.Relative 5.Estimate 8.
		3.Tenant 6.Other 9.

GARAGE 24X26

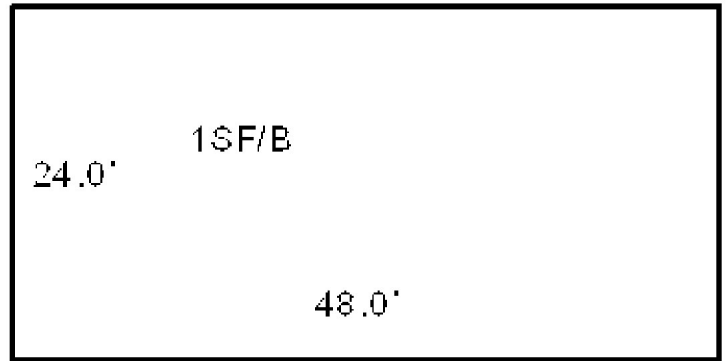

Date Inspected 3/15/2007

Additions, Outbuildings & Improvements

Type	Year	Units	Grade	Cond	Phys.	Funct.	Sound Value	
23 Frame Garage	2001	624	3 100	4	0 %	100 %		1.ONE STORY FRAM
					%	%		2.TWO STORY FRAM
					%	%		3.THREE STORY FR
					%	%		4.1 & 1/2 STORY
					%	%		5.1 & 3/4 STORY
					%	%		6.2 & 1/2 STORY
					%	%		21.Open Frame Por
					%	%		22.Encl Frame Por
					%	%		23.Frame Garage
					%	%		24.Frame Shed
					%	%		25.Frame Bay Wind
					%	%		26.1SFr Overhang
					%	%		27.Unfin Basement
					%	%		28.Unfinished Att
					%	%		29.Finished Attic



Map Lot U19-015

Account 1823

Location 61 SHADY LANE

Card 1 Of 1 10/05/2023

FISHER, DONALD G J/T
FISHER, DEBRA A
WISCASSET ME 04578

B4058P118

Previous Owner
WILLIAMS, DARREN M.

61 SHADY LANE
WISCASSET ME 04578
Sale Date: 9/30/2008

Inspection Witnessed By:

X

Date

No./Date	Description	Date Insp.

Notes:

2002-PREVIOUS OWNER:DARREN & TAMELA WILLIAMS
BK2019 PG0253 & BK2713 PG290. BOUGHT LAND ONLY IN
1994 FOR \$18,000.

2009-Previous owner: Darren M. Williams BK2713 PG290.

WISCASSET

Property Data

Neighborhood	109 SOUTHEAST		
Tree Growth Year	0		
FARM LAND YEAR	0		
OPEN SPACE YEAR	0		
Zone/Land Use	21 RURAL		
Secondary Zone			
Topography	1 Level		
1.Level	4.Below St	7.Steep	
2.Rolling	5.Low	8.Rough	
3.Above St	6.Swampy	9.	
Utilities	4 Drilled Well	6 Septic System	
1.Public	4.Dr Well	7.Cesspool	
2.Water	5.DUG/LAKE	8.	
3.Sewer	6.Septic	9.None	
Street	1 Paved		
1.Paved	4.Proposed	7.	
2.Semi Imp	5.Private	8.	
3.Gravel	6.Pub Eas	9.NoStreet	
TREE GROWTH PLAN	0		
CONSERV EASE	0		
Sale Data			
Sale Date	9/30/2008		
Price	165,000		
Sale Type	2 Land & Buildings		
1.Land	4.Mobile	7.	
2.L & B	5.Other	8.	
3.Building	6.	9.	
Financing	9 Unknown		
1.Convent	4.Seller	7.	
2.FHA/VA	5.Private	8.	
3.Assumed	6.Cash	9.Unknown	
Validity	1 Arms Length Sale		
1.Valid	4.Split	7.Renovate	
2.Related	5.Partial	8.Other	
3.Distress	6.Exempt	9.Foreclose	
Verified	5 Public Record		
1.Buyer	4.Agent	7.Family	
2.Seller	5.Pub Rec	8.Other	
3.Lender	6.MLS	9.	

Assessment Record

Year	Land	Buildings	Exempt	Total
2010	36,900	128,400	10,000	155,300
2011	36,900	128,400	10,000	155,300
2012	36,900	128,400	10,000	155,300
2013	36,900	128,400	10,000	155,300
2014	36,900	128,400	10,000	155,300
2015	36,900	128,400	10,000	155,300
2016	36,900	128,400	15,000	150,300
2017	36,900	128,400	20,000	145,300
2018	36,900	128,400	20,000	145,300
2019	36,900	128,400	20,000	145,300
2020	36,900	128,400	25,000	140,300
2021	36,900	128,400	25,000	140,300
2022	36,900	128,400	24,000	141,300
2023	46,100	160,500	25,000	181,600

Land Data

Front Foot	Type	Effective		Influence		Influence Codes
		Frontage	Depth	Factor	Code	
11.Regular Lot				%		1.Open Space
12.Delta Triangle				%		2.Neighborhood A
13.Nabla Triangle				%		3.Topography
14.Rear Land				%		4.Size/Shape
15.Front Foot				%		5.Access
				%		6.Restriction
				%		7.Corner/Locatio
				%		8.View/Environ
				%		9.Fract Share
				%		Acres
				%		30.Rear 20+
				%		31.Waterfront Rea
				%		32.Open Space
				%		33.RestrictEsm
				%		34.PASTURE 1
				%		35.HORTICULTURAL-
				%		36.Pasture 3
				%		37.Softwood
				%		38.Mixed Wood
				%		39.Hardwood
				%		40.Wasteland
				%		41.CAMP SITE
				%		42.Mobile Home Si
				%		43.Condo Site
				%		44.Site Improve
				%		45.CAMP SITE
				%		46.PAVING/00
Total Acreage		1.29				

WISCASSET

Map Lot U19-015

Account 1823

Location 61 SHADY LANE

Card 1

Of 1

10/05/2023

Building Style 2 Ranch	SF Bsmt Living 0	Layout 1 Typical
1.Conv. 5.Colonial 9.Other	Fin Bsmt Grade 0 0	1.Typical 4. 7.
2.Ranch 6.Split 10.Double	HEARTH 0	2.Inadeq 5. 8.
3.R Ranch 7.Mod/Cont 11.Multi	Heat Type 100% 1 Hot Water BB	3. 6. 9.
4.Cape 8.Log 12.Cot.	1.HWBB 5.FWA 9.No Heat	Attic 9 None
Dwelling Units 1	2.HWCI 6.GravWA 10.	1.1/4 Fin 4.Full Fin 7.
Other Units 0	3.H Pump 7.Electric 11.	2.1/2 Fin 5.F/Stair 8.
Stories 1 One Story	4.Steam 8.F/Wall 12.	3.3/4 Fin 6. 9.None
1.1 4.1.5 7.	Cool Type 0% 9 None	Insulation 1 Full
2.2 5.1.75 8.	1.Refrig 4.W&C Air 7.	1.Full 4.Minimal 7.
3.3 6.2.5 9.	2.Evapor 5. 8.	2.Heavy 5.Unknown 8.
Exterior Walls 8 ALUM/VINYL	3.H Pump 6. 9.None	3.Capped 6. 9.None
1.CLAP 5.T-111 9.OTHER	Kitchen Style 2 TYPICAL	Unfinished % 0%
2.WD SH 6.BR/STONE 10.	1.GOOD 4.Obsolete 7.	Grade & Factor 3 Average 100%
3.COMP 7.NOV 11.	2.TYPICAL 5. 8.	1.E Grade 4.B Grade 7.AA+ Grad
4.ASB/ASP 8.AL/VIN 12.	3.OLD TYPE 6. 9.None	2.D Grade 5.A Grade 8.AA++Grad
Roof Surface 1 Asphalt Shingles	Bath(s) Style 2 TYPICAL	3.C Grade 6.AA Grade 9.Same
1.Asphalt 4.Composit 7.	1.GOOD 4.Obsolete 7.	SQFT (Footprint) 1512
2.Slate 5.Wood 8.	2.TYPICAL 5. 8.	Condition 4 Average
3.Metal 6.Other 9.	3.Old Type 6. 9.None	1.Poor 4.Avg 7.V G
SF Masonry Trim 0	# Rooms 6	2.Fair 5.Avg+ 8.Exc
OPEN-3-CUSTOM 0	# Bedrooms 3	3.Avg- 6.Good 9.Same
OPEN-4-CUSTOM 0	# Full Baths 2	Phys. % Good 0%
Year Built 1994	# Half Baths 0	Funct. % Good 100%
Year Remodeled 0	# Addn Fixtures 0	Functional Code 9 None
Foundation 1 Concrete	# Fireplaces 0	1.Incomp 4.SMALL 7.LAYOUT
1.Concrete 4.Wood 7.		2.O-Built 5.CDU 8.OTHER
2.C Block 5.Slab 8.		3.Defmaint 6.STYLE 9.None
3.Br/Stone 6.Piers 9.		Econ. % Good 100%
Basement 4 Full Basement		Economic Code None
1.1/4 Bmt 4.Full Bmt 7.		0.None 3.Services 9.None
2.1/2 Bmt 5.None 8.		1.Location 4.Traffic 8.
3.3/4 Bmt 6. 9.None		2.Encroach 8.Other 9.
Bsmt Gar # Cars 0		Entrance Code 5 Estimated
Wet Basement 1 Dry Basement		1.Interior 4.Vacant 7.
1.Dry 4. 7.		2.Refusal 5.Estimate 8.
2.Damp 5. 8.		3.Informed 6. 9.
3.Wet 6. 9.		Information Code 5 Estimate
		1.Owner 4.Agent 7.
		2.Relative 5.Estimate 8.
		3.Tenant 6.Other 9.

Date Inspected 12/08/2006

Additions, Outbuildings & Improvements

Type	Year	Units	Grade	Cond	Phys.	Funct.	Sound Value	
68 Wood Deck	0	100	0 0	0	0 %	0 %		1.ONE STORY FRAM
68 Wood Deck	2004	128	3 100	4	0 %	100 %		2.TWO STORY FRAM
					%	%		3.THREE STORY FR
					%	%		4.1 & 1/2 STORY
					%	%		5.1 & 3/4 STORY
					%	%		6.2 & 1/2 STORY
					%	%		21.Open Frame Por
					%	%		22.Encl Frame Por
					%	%		23.Frame Garage
					%	%		24.Frame Shed
					%	%		25.Frame Bay Wind
					%	%		26.1SFr Overhang
					%	%		27.Unfin Basement
					%	%		28.Unfinished Att
					%	%		29.Finished Attic

